

INSTALLATION MANUAL & OPERATION INSTRUCTIONS

TIRE CHANGER INSTALLATION PSE TC-260 Manual

PSE TC-260

Commercial Grade Tire Changer
43" Maximum Tire Diameter

Call Your Distributor Today!
**EXTENDED
WARRANTY**
Protect Yourself For An
Additional 12 Months
Contact Distributor For Details!
**Warranties Go Away
Equipment Stays!**

PSE TC-260 FEATURES:

- JET BLAST Air Bead Seating System
- Pneumatic Bead Breaker
- Manual Operation Mounting
Demounting Tool
- Complete Tire Changing Tool Kit
- OPTIONAL Pneumatic Helper Arm Available!
- OPTIONAL Adapters & Mounting / Demounting
"Duckheads" Available!
- **1 YEAR LIMITED WARRANTY**
- Many More Products Available!



Thank You For Your Purchase!

We reserve the right to make changes in specifications
without notice and without making changes retroactive.

**KEEP THIS MANUAL NEAR THE MACHINE AT ALL
TIMES AND MAKE SURE ALL USERS HAVE READ
THIS MANUAL BEFORE OPERATING THIS MACHINE.**

PRO-SERIES

Equipment

www.ProSeriesEquipment.com

P.O. Box 734
Franklin, Indiana 46131
1-800-708-2988

Email: Sales@ProSeriesEquipment.com

This Page Intentionally Left Blank

1 SUMMARY	2
1.1 Technical data.....	2
1.2 RANGE OF APPLICATION	2
1.3 STRUCTURE	3
1.4 ACCESSORIES PROVIDED:.....	3
2 SAFETY REQUIREMENT AND NOTICE ITEMS	5
2.1 Intended Use	5
2.2 General Safety Precautions.....	5
2.3 Danger warning signs.....	6
3 TRANSPORT	7
4 UNPACKING	7
5 INSTALLATION	7
5.1 Circumstance and space required.....	7
5.2 Installation assembly	8
5.3 Positioning the machine	9
5.4 Pneumatic and Electrical Connection.....	10
5.5 Operating test	10
6 OPERATION	11
6.1 Breaking the Bead.....	11
6.2 Demounting the Tire	12
6.3 Mounting the tire	14
7 INFLATING	15
7.1 Inflating tire with inflation gun	15
7.2 Inflating with TI SYSTEM (optional).....	15
8 MOVING	16
9 STORAGE	16
11 MAINTENANCE	17
11.1 General warning	17
11.2 Maintenance	17
12 Trouble Shooting	20
13.1 Accessories Standard.....	21
13.2 Accessories Required.....	21
13 Accessories List	21
PARTS MANUAL	22

1 SUMMARY

Thank you for purchasing product from a line of Tire Changers. This manual is an important part of the product. Before using the Tire Changer read carefully the warnings and instructions contained in this manual since they provide important information about operation safety and maintenance.

Keep this manual for future reference.

1.1 Technical data

Force on bead breaker:	1,135 LBS. (2500kg)
Operating pressure:.....	115 ~ 145 PSI (0.8-1.0Mpa)
Power supply voltage:	220V / 110V / 380V
Motor power:.....	1,100 W / 750 W
Frequency:.....	50Hz
Current:.....	4.7A
Noise pressure level in working conditions:.....	< 70dB

1.2 RANGE OF APPLICATION

Max diameter:.....	43.5" (1100 mm)
Max width:	12.5" (315 mm)
Rim clamping outside:	11"~ 20" (280 mm ~ 508 mm)
Rim clamping inside:	13" ~ 24" (330 mm ~ 609 mm)

STRUCTURE:

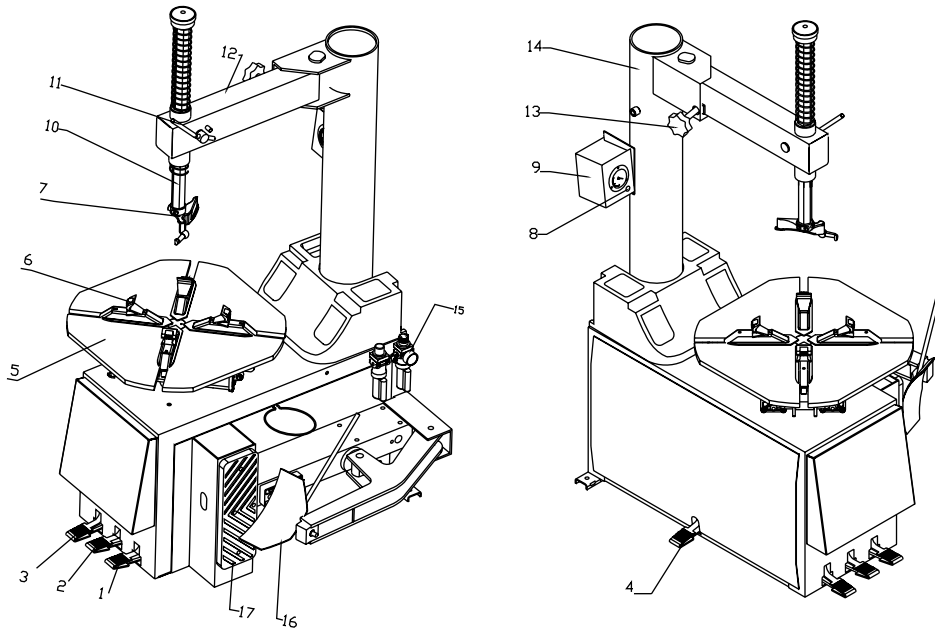

- | | |
|-------------------------------|---|
| 1. Reverse Control Pedal | 10. Mounting Bar |
| 2. Bead breaker Control Pedal | 11. Locking Knob |
| 3. Clamping Control pedal | 12. Horizontal Arm |
| 4. Inflating Pedal | 13. Locking Handle |
| 5. Turntable | 14. Vertical Arm |
| 6. Jaws | 15. Water Separator +Pressure Regulator+ Lubricator |
| 7. Mounting head | 16. Bead Breaking Plate |
| 8. Deflating button | 17. Wheel Support |
| 9. Air pressure gauge | |

ACCESSORIES PROVIDED:

Tire Tool - This tool is for lifting the tire bead onto the mounting head during the demounting stage (shown in figure 1-1).

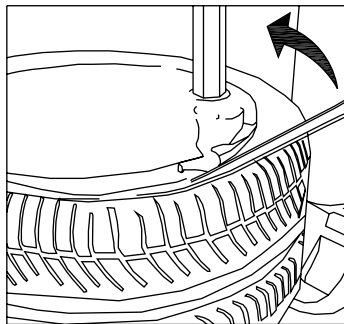

Figure 1-1

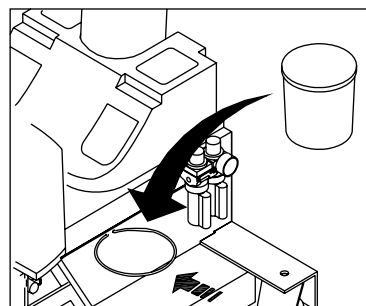

Figure 1-2

- Lubrication Tub Ring - This ring hold the lubrication tub. Once the machine has been installed, the ring is fitted on the machine (shown in figure 1-2).
- Lubrication Tub - it is use for holding lubrication (shown in figure 1-3).

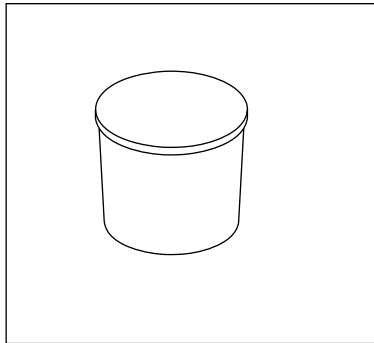

Figure 1-3

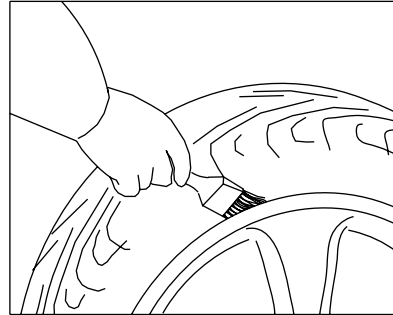

Figure 1-4

- Brush - this is provided for lubricating the tire beak after the tire beads are detached from the rim (shown in figure 1-4)
- Tire Tool Guard - This rubber grip is fitted on the Tire Tool to protect the rim from being damaged by the Tire Tool (shown in figure 1-5)

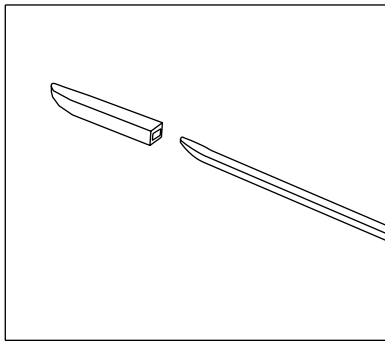

Figure 1-5

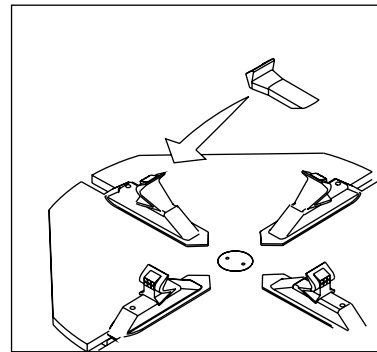

Figure 1-6

- Jaw Guards - Fit onto the clamping jaws to protect the rim from damage by the Clamping Jaws (shown in figure 1-6).
- Mounting Head Guards - These plastic / nylon inserts are placed into the mounting head to protect the rim from being damaged by the mounting head (shown in figure 1-7).

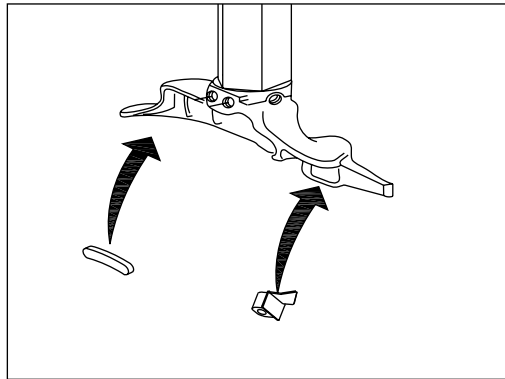

Figure 1-7

2. SAFETY REQUIREMENT AND NOTICE ITEMS

2.1 Intended Use

- This Tire Changer has been designed and manufactured exclusively for demounting and mounting tires from 11" ~ 24" (279.5 mm ~ 610 mm) and a maximum diameter of 43.5" (1,100 mm). Using this machine for any other uses will void the warranty.
- The manufacturer is not responsible for any damage caused through the use of this Tire Changer for purposes other than those specified within this manual.

2.2 General Safety Precautions

- The Tire Changer can only be operated by trained and authorized personnel.
- Any tampering and modification to the equipment carried out without the manufacturer's prior authorization frees that manufacturer from all responsibility for damage caused directly or indirectly by the above actions.
- This Tire Changer comes with complete installation / operation instructions and also warning signs that are designed to be long-lasting. If these should for any reason be damaged or destroyed, please ask the manufacturer immediately for replacements.
- Keep the machine away from combustible, explosive objectives. Avoid strong light and sunshine. Good ventilation is needed.
- The operator must keep the installation site clean and free of debris.
- Make sure to only use original manufacturer spare parts and accessories.
- This machine is to be installed by authorized personnel according to manual.
- If during installation there is any trouble or you notice any problems with the equipment, stop working and contact manufacturer.
- Unauthorized personnel should be kept away from the machine
- Operators must wear protective equipment comply with OSHA safety rules (glove, eye-protection glasses, ear protection device and safety footwear) to avoid any accidental injuries.

- Regularly check this machine before use to ensure that the electrical system is well grounded.
- Press the bead breaking pedal before every use to check the water separator / pressure regulator / lubricator. Make sure it supplies oil to the air pad system and works normally. To assure every part of air pad system is lubricated very well under normal demounting tire condition .

2.3 Danger warning signs

This Tire Changer comes with complete instructions and warning signs that are designed to stay on the machine. If these warnings should for any reason be damaged, destroyed or lost, please ask immediately for replacements from the manufacturer.

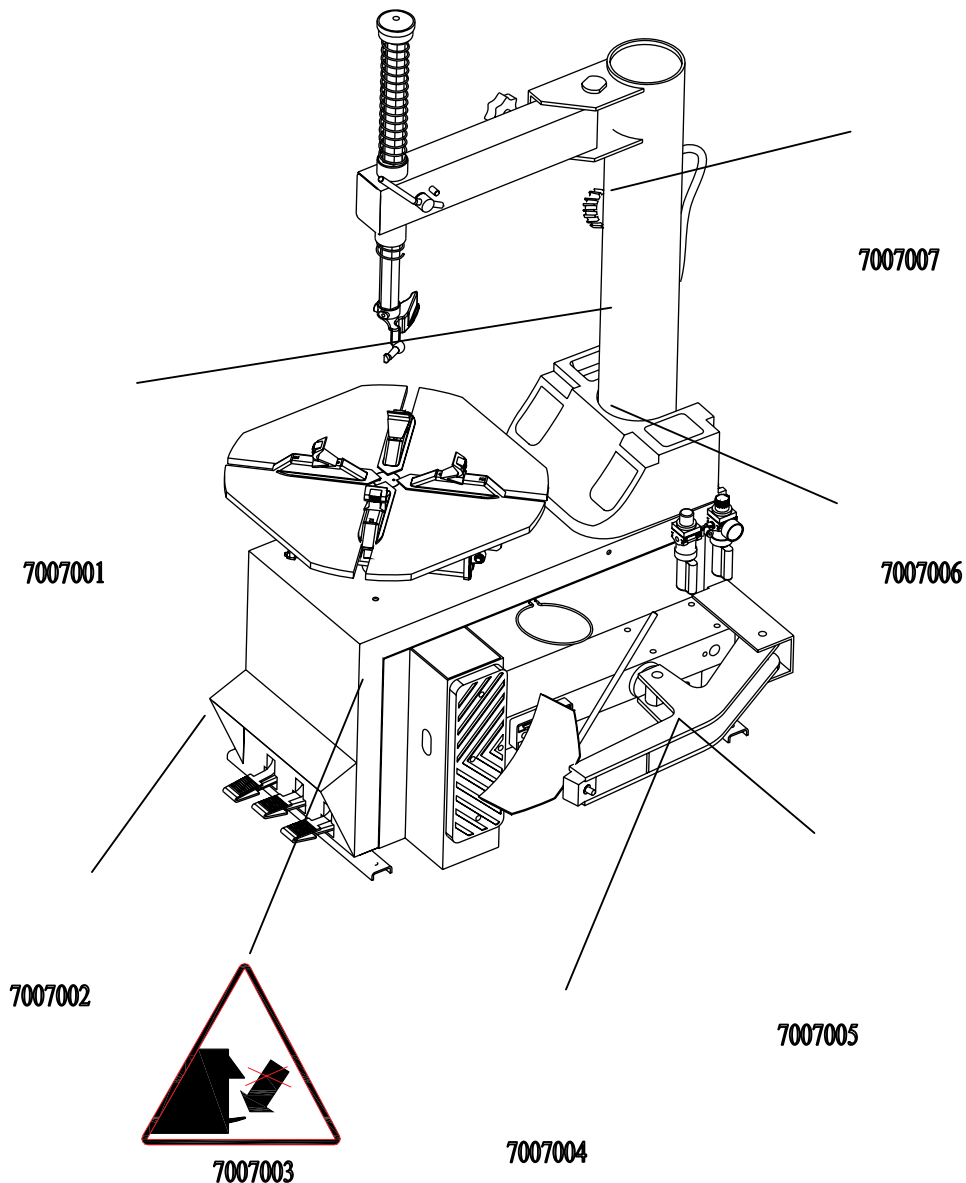

3 TRANSPORT

- The Tire Changer must be transported in its original packaging and kept in the position shown on the package itself.
- The packaged machine should be moved by a fork lift of suitable capacity. Insert the forks at the points shown at figure below.

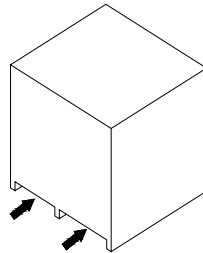

4 UNPACKING

- Use proper protective equipment to unpack (gloves etc)
- Check that the equipment is in perfect condition, make sure that no parts are damaged or missing. If in doubt, do not use the machine and contact your retailer.
- Read the packing list carefully and check the quantity. If in doubt, contact your retailer.
- Put the packing materials (plates, nails, screws and plastic bags) in a safe place.

5 INSTALLATION

5.1 Circumstance and space required

Circumstance required:

Temperature 39.2 °F ~ 104°F
Above sea level < 3,280 ft.
Humidity.....50% @ 104°F ~ 90% @ 68°F

Other Considerations:

- When choosing the place to install your equipment, make sure that it complies with current safety regulations.
- This machine must be connected to the main electric power supply and the compressed air system. Therefore it is advisable to install the machine near these two power sources.
- The installation area must also provide at least the space shown in the following figure so as to allow all parts of the machine to operate correctly and without any restriction.
- The installation area should be well lit to make the machine easier and safer to operate.
- If the machine is installed outside, it must be protected from sunshine, rain, and other bad weather.
- Only operators should be in the work area while the machine is working

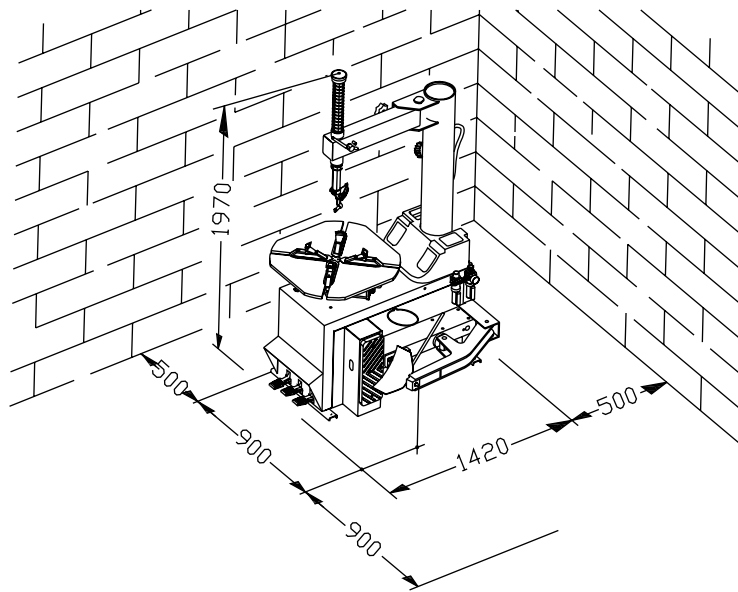

5.2 Installation assembly

5.2.1 Vertical arm installation (OPTIONAL):

- Unscrew the pallet fixing screws(1), washers(2) and box(3)(figure 5-1)
- Unscrew the pallet fixing screws (4) lock washers (5) washers (6) (figure 5-1)
- Wrap the strap (mod. DR 100 of 1 m factor 6:1) around the horizontal arm and raise the tilting arm with a hoist (shown in figure).
- Take care not to crush the hose and the union
- Put the vertical arm on the machine cabinet (figure 5-2).
- Mount washers (6) lock washers (5) and screws (4), tighten the screws, mount box(3) washers(2) and screws(1)(figure 5-2).

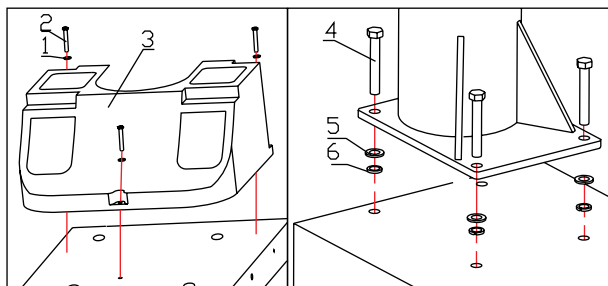

Figure 5-1

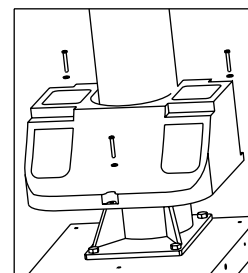

Figure 5-2

5.2.2 Spring installation

- Hold up the mounting arm at a certain distance, dismantle screws (1), cap (2), mount the spring(3) and tighten screws(1) (figure 5-3)

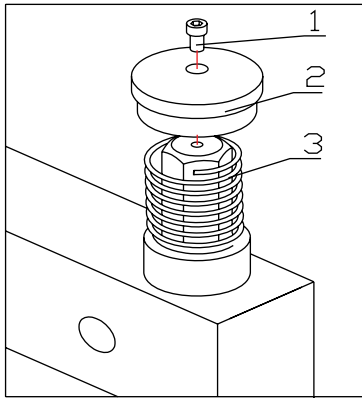

Figure 5-3

5.2.3 Wheel rubber support installation

Dismantle the screw (1), washer (2) from the cabinet. Then Fix the wheel rubber support (figure 5-4).

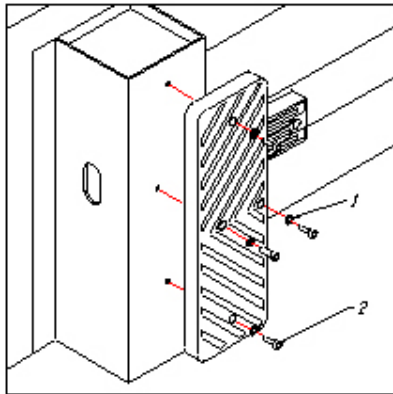

Figure 5-4

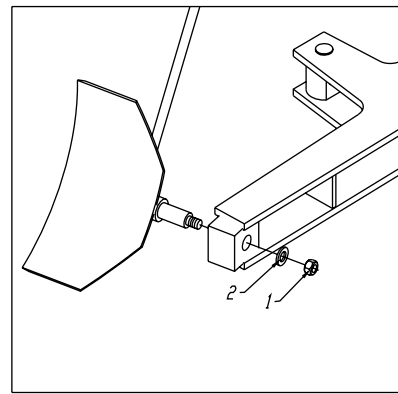
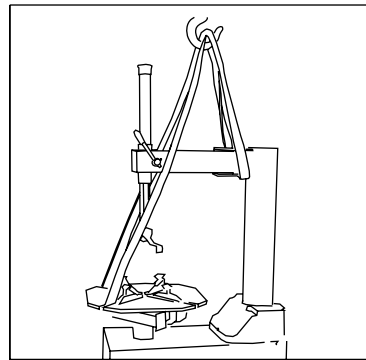
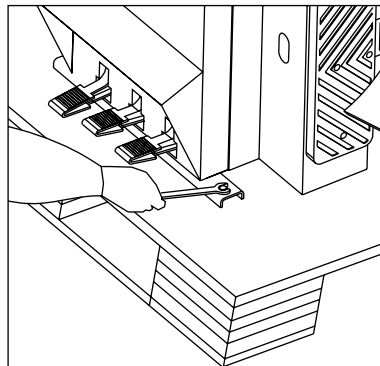

Figure 5-5

5.3 Positioning the machine



- Dismantle the nuts and the screws which fix the machine cabinet to the pallet
- Wrap the strap (mod. DR 650 of 3 m and DR 650 of 1.5 m factor 6:1) (shown in figure).
- Raise the machine with a hoist.
- Remove the pallet and position the machine.

- Take care not to crush the hose and the union.
- The machine is fitted with special rubber feet for eliminating vibrations.
- To inflate tires on the turntable it is obligatory to fix the machine to the ground.
- Fix the machine to the ground with the screws (4ps M10 CS12.9). using the same holes provided for fixing the machine to the pallet.

5.4 Pneumatic and Electrical Connection

CAUTION: Check that the characteristics of your systems before connection.

- Even small jobs done on the electrical system must be carried out by trained personnel.
- Connect the machine with the electrical network, which must be provided with line fuses (6 A). A good ground socket in compliance with regulations in force and it must be connected to automatic circuit breaker (25A).

NOTE: If the Tire Changer doesn't have a plug, the user must prepare plug with at least 16A rating which conforms to the voltage of the machine, in compliance with the regulations in force.

- Electric supply tolerances should be provided in documentation (120V / 60 Cycles). Under voltage and over voltage protection device should be provided in the user power supply system.

5.5 Operating test

- When the pedal (1) is pressed down the turntable should turn in clockwise direction. When the pedal is pulled up the turntable should turn in the counter-clockwise direction.
- Press the pedal (2) activates the bead breaker; when the pedal is released the bead breaker returns to its original position.
- Press the pedal (3) opens the four clamps; when the pedal is pressed again they close.

Those with TI Function:

- When the pedal (4) located on the left side of the machine is pressed down to the first gear, air is released from the airline gauge. Gauge 9 will indicate the pressure after release of air.
- When the pedal (4) located on the left side of the machine is pressed down to the second gear, air is released from the airline gauge along with a powerful jet from the nozzles located on the turntable clamps.
- Press button (8) to deflate extra air out of the tire.
- Don't lean on the turntable during operation. The operator's eyes will be hurt by dirt and dust on the turntable. For the same reason, it is better push the inflating pedal carefully while working.

6 OPERATION

Don't use the machine until you have read and understood the entire manual and the warnings contained in the manual.

The operation of the Tire Changer is divided into three parts:

1. Breaking the Bead
2. Demounting the Tire
3. Mounting the Tire

Before carrying out any operation, deflate the tire and take off all wheel balancing weights.



DURING THE OPERATION, KEEP HANDS CLEAR OF ALL PINCH POINTS!

6.1 Breaking the Bead



CAUTION: Bead breaking must be done with the utmost care and attention. When the bead breaker pedal is operated, the bead breaker arm moves quickly and powerfully. Anything within the action range of bead breaker arm can be in the danger of being crushed.

- Check whether the tire is deflated or not.
- Close the turntable clamps completely.



CAUTION: Bead breaking with the clamps in the open position can be extremely dangerous for operator hands. During bead breaking operations never touch the side of the tire.

- Position the wheel against the rubber stop on the right side of the Tire Changer.
- Position the bead breaking blade against the tire bead at a distance of about 1 cm from the rim. Pay attention to the blade, which must be correctly onto the tire not onto the rim.
- Press down the pedal to activate the bead breaker and release it when the blade has reached the end of its travel or in any case when the bead is broken.
- Rotate the tire slightly and repeat the operation around the entire circumference of the rim and from both sides until the bead is completely detached from the rim.

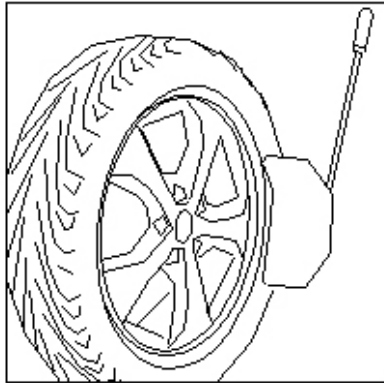

Figure 6-1

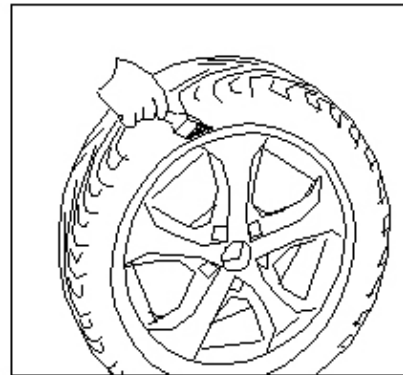

Figure 6-2

6.2 Demounting the Tire

WARNING: Before any operations remove the old wheel balancing weights and check that the tire is deflated.

- Clean the turntable.
- Spread the grease onto the tire bead.

WARNING: Failure to use the grease risks causing serious damage the tire bead. Using the lubricant specifically produced for touring tires.

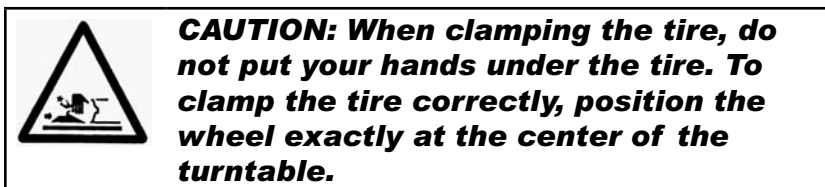

Rim locking from outside:

- Position the clamps according to the reference mark on the turntable by pressing the pedal down to its intermediate position.
- Place the tire on the clamps and, keeping the rim pressed down, press the pedal (3) as far as it will go.

CAUTION: When placing the tire onto the turntable. Lift the tire less than 25kg by one person. Lift the tire more than 25kg but less than 50kg by two persons, Lift the tire more than 50kg by special lifting device.

Rim locking from inside:

- Position the clamps so that they are completely closed.
- Place the tire on the clamps and press down the pedal (3) to open the clamps and thereby lock the rim.

CAUTION: Make sure the rim is firmly fixed to the clamps.

- Use only lubricant solutions specifically produced for touring tires
- Move the horizontal arm to position the mounting head near the rim.

- Unlock the locking lever, release mounting bar.
- Lower the mounting bar until the mounting head rest against the edge of the rim and lock it using the locking lever. This way the mounting bar is locked in a vertical direction and the mounting head is automatically moved a distance of about 2-3mm from the rim in vertical direction.
- Adjust the locking knob to remove the mounting head a distance of 2-3mm from the rim.

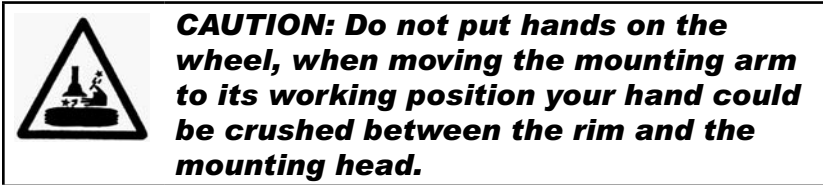

- With the lever between the bead and the front section of the mounting head, move the tire bead over the mounting head.

NOTE: In order not to damage the inner tube, if there is one, it is advisable to carry out this operation with the valve 10cm to the right of the mounting head.

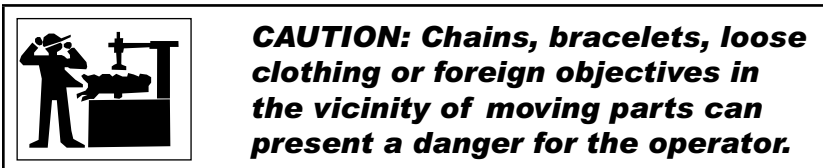

- With the lever held in this position, rotate the turntable in a clockwise direction by pressing down on pedal until the tire is completely separated from the wheel rim.
- To prevent accidents, keep hands and other parts of the body as far as possible from the tool arm when the table top is turning.
- Remove the inner tube if there is one, do not release the mounting arm, press down pedal (4), directly tilt the vertical arm.
- Repeat the operation for the other tire bead

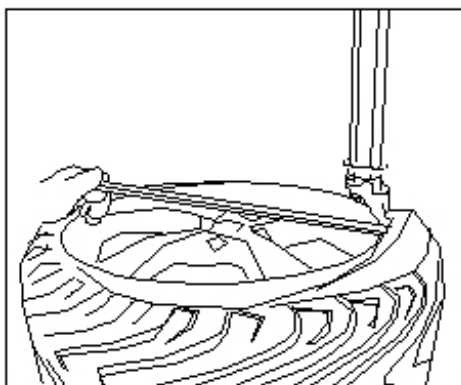

Figure 6-3

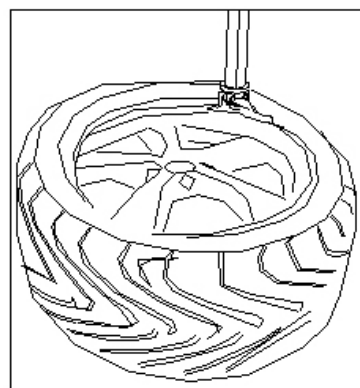

Figure 6-4

6.3 Mounting the tire

WARNING: This checking of tire and rim is of utmost importance to prevent tire explosion during the inflating operation. Before beginning mounting operation make sure that:

- The tire and the cord fabric are not damaged. if you note the defects do not mount the tire.
- The rim is without dents and is not warped. Pay attention to alloy rims, dents cause internal micro-cracks not visible to naked eye. This can compromise the rim and also be the source of danger especially during inflation.
- The diameter of the rim and tire are exactly the same. Never try to mount a tire on a rim if you cannot identify the diameter of both.
- Lubricate the tire beads with the special grease in order to avoid damaging them and to facilitate the mounting operations.

NOTE: When you are working with the rims of the same size, it is not necessary always to lock and unlock the mounting bar. Just swing and restore the horizontal arm with the mounting arm locked.

- Move the tire so that the bead passes below the front section of the mounting head and is brought up against the edge of the rear section of the mounting head itself.
- Keep the tire bead pressed down into the wheel rim channel with your hands, press down on the pedal (1) to rotate the turntable clockwise. Continue until you have covered the whole circumference on the wheel rim.
- Insert the inner tube (if there is one). Repeat the same operations to mount the upper side of the tire.

NOTE: Dismounting and mounting are always done with the clockwise turntable rotation. Counter-clockwise rotation is used only to correct operator error or if the turntable stalls.



CAUTION: Do not put hands on the wheel, when moving the mounting arm to its working position your hand could be crushed between the rim and the mounting head.

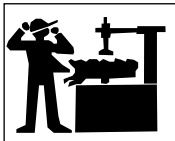

CAUTION: Chains, bracelets, loose clothing or foreign objectives in the vicinity of moving parts can represent a danger for the operator.

7 INFLATING

CAUTION: The greatest attention is called for when inflating the tires. Follow the instructions closely since the Tire Changer is not designed and built to protect the user (or anyone else in the vicinity of the machine) if the tire fails / explodes.



CAUTION: Tire break can cause serious injury or even death of the operator. Check carefully that the wheel rim and the tire are of the same size. Check the state of wear of the tire and that it has no defects before beginning the installation stage. Inflate the tire with brief jets of air. Check the pressure after every jet. Maximum inflating pressure is 3.5bar.in any case never exceed the pressure recommended by the manufacturer.

Keep your hands and body away from the tire.

7.1 Inflating tire with inflation gun

Inflate a tire step by step as following:

- Connect the airline gauge fitting to the tire valve.
- Make a last check to be certain that the tire and rim diameter correspond.
- Between air jets, constantly check the pressure until required pressure has been reached.

WARNING: Explosion hazard!

Never exceed 3.5bar, when inflating tire on a fixed position. If a higher inflating pressure is required, remove the wheel from the turntable and continue the inflation inside a special protection cage (commercially available). Never exceed the max. Inflating pressure given by the tire manufacturer. Always keep hands and body away from inflating tire. Only specially trained personnel are allowed to perform these operations. Do not allow other persons to operate or to stay near the Tire Changer.

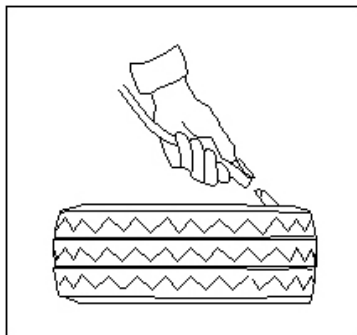

Figure 7-1

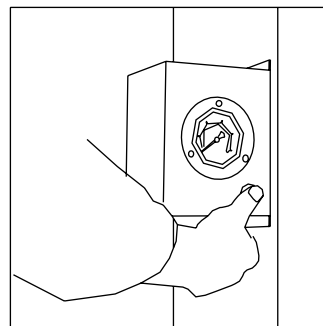

Figure 7-2

7.2 Inflating with TI SYSTEM (optional)

- The TI inflation system facilitates inflation of tubeless tires thanks to a powerful jet of air from the nozzles positioned on the clamps.
- During this phase of work, the level of noise can reach 85db(A), it is advisable to use a noise protection.

- Lock the wheel on the turntable and connect the inflation head to the tire valve.
- Check to be certain that rim and beads are sufficiently lubricated.
- Make a last check to be certain the tire and rim diameter correspond. press the pedal (4) down to the first gear, direct inflating.
- If the bead of tire is not well seated, due to a strong bead, lift tire manually until the upper bead seals against the rim ,then press the pedal(4) all the way down the second gear, a strong jet of air will be released through the nozzles in the slides and this will help the bead seal.
- Release the tire, set the pedal to the first gear, and continue to inflate the tire with short jets of air and constantly checking the pressure between air jets until the required pressure has been reached.
- If tire pressure is higher, press button (8) on gauge (9),it will release excess pressure.

Explosion Hazard!

Never exceed 50 PSI when inflating tire on a fixed position! If a higher inflating pressure is required, remove the wheel from the turntable and continue the inflation inside a special protection cage (commercially available). Never exceed the max. Inflating pressure given by the tire manufacturer. Always keep hands and body away from inflating tire. Only specially trained personnel are allowed to perform these operations. Do not allow other persons to operate or to stay near the Tire Changer.

8 MOVING

- Disconnect the pneumatic and electric power supplies.
- Wrap the strap (mod. DR 650 of 3 m and DR 650 of 1.5 m factor 6:1) (shown in figure).Raise the machine with a hoist.
- Remove the pallet and position the machine.
- Take care not to crush the hose and the union.

9 STORAGE

In the event of storage for long periods of time make sure to disconnect all sources of power and lubricate the clamp sliding guides on the turntable to prevent rusting.

Environment required:

Temperature (-13 °F ~ 131°F)

Keep the machine away from combustible ?explosive objectives. Avoid strong light and sunshine. Adequate ventilation is required.

10 DESTROY

If you decide to destroy the machine, make sure to make it inoperative by disconnecting it from all sources of power.

- Remove all non-ferrous materials and dispose of them as prescribed by rules lawfully.
- Collect the oil and dispose of it at an authorized point as prescribed by rules lawfully.
- Destroy the remained ferrous material.

11 MAINTENANCE

11.1 General warning

Unauthorized personnel may not carry out maintenance work.

- Regular maintenance as described in the instructions is essential for correct operation and long life of the Tire Changer.
- If maintenance is not carried out regularly, the operation and reliability of the machine may be compromised, thus placing the operator and anyone else in the vicinity at risk.
- Before carrying out any maintenance work, disconnect the electric and pneumatic supplies. Moreover, it is necessary to depress bead breaker pedal 3-4 times in order to let the air in the circuit go out.
- Defective parts must be replaced exclusively with spare parts offered by manufacturer.
- Removing or tampering with safety devices (pressure limiting and regulating valves) represents a violation of safety regulations.
- In particular: the manufacturer shall not be held responsible for complaints deriving from the use of spare parts made by other manufacturers or for damage caused by tampering or removal of safety systems.

11.2 Maintenance

- Clean the turntable once a week with diesel fuel so as to prevent the formation of dirt, and grease the clamp sliding guides.
- Carry out the following operations at least once every 30 days:
- Check the oil level in the lubricator tank. If necessary, fill up by unscrewing screw 1 (figure 11-1)
- Check if there is a drop of oil leakage every 10 times the pedal (2) is pressed down. If not, regulate using the screw (2) (figure 11-2)?
- Retighten the clamp tightening screws (1) and the screws on the turntable sliders (2).

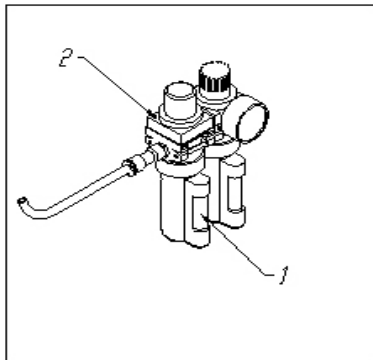

Figure 11-1

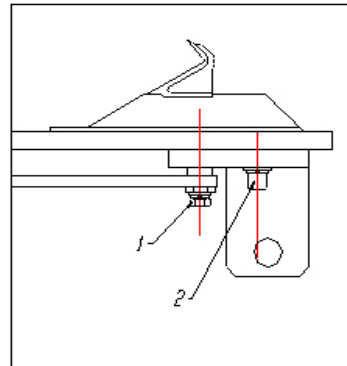

Figure 11-2

If the turntable doesn't work, it may be caused by a loose drive belt, check the following:

- Before any use, disconnect the electric power supplies.
- Remove the left side body panel of the Tire Changer.

- Tighten the drive belt by means of the special adjusting screw (1) on the motor support until the belt moves 8 mm when adding a stress of 18 LBS on the belt.
- It is necessary to adjust the screw (1) in the locking plate of the mounting arm, if the mounting head doesn't lock or it doesn't rise from the rim of 2mm necessary for working.(figure 11-4)

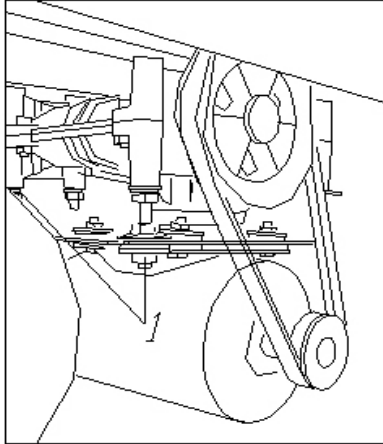

Figure 11-3

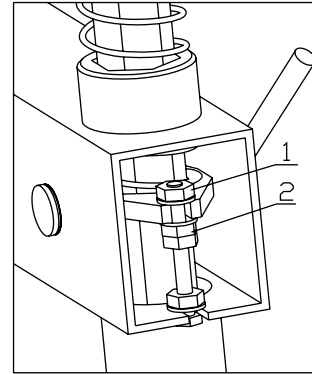

Figure 11-4

If the clamps open/close slowly, it is necessary to clean or replace the silencer for opening/closing clamps, and proceed as follows:(figure 11-5)

1. Dismantle the protective hood of the machine.
2. Unscrew the silencer on the clamp opening/closing pedal.
3. Clean by compressed air. The silencer should be replaced by if damaged.

If the speed of the bead breaking plate becomes slow, it maybe necessary to clean or replace the silencer of bead breaking blade, and proceed as shown (figure 11-6):

1. Remove the protective hood of the machine.
2. Unscrew the silencer put on the bead breaker blade pedal.
3. Clean by compressed air. The silencer should be replaced if damaged.

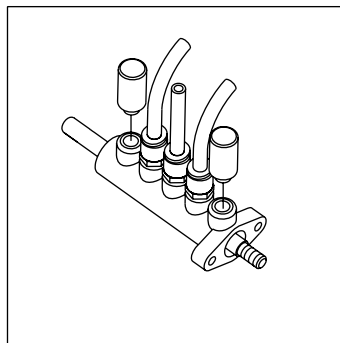

Figure 11-5

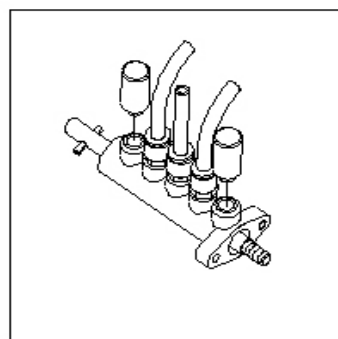

Figure 11-6

Oil Table	
Gear box oil type	Lubricating oil type for pneumatic system
ESSO SPARTAN EP460	ESSO FEBIS K32
ISO 460	ISO 32
DIN 51502-CLP	
ISO 34-98-CC	

The manufacturer will not be responsible for any damage resulting from the use of different oils.

Machine with TI system should have air tank.. Every year should inspect tank according to local rule. Tank fixed number of year is 5 years, and after 5 years, tank should disposed of according to local codes.

4 Lead Motor

110v-1PH

11-2	x		x
9-10	x		x
7-8	x		
5-6			x
3-4			x
1-2	x		
Contact to Contact	L	O	R

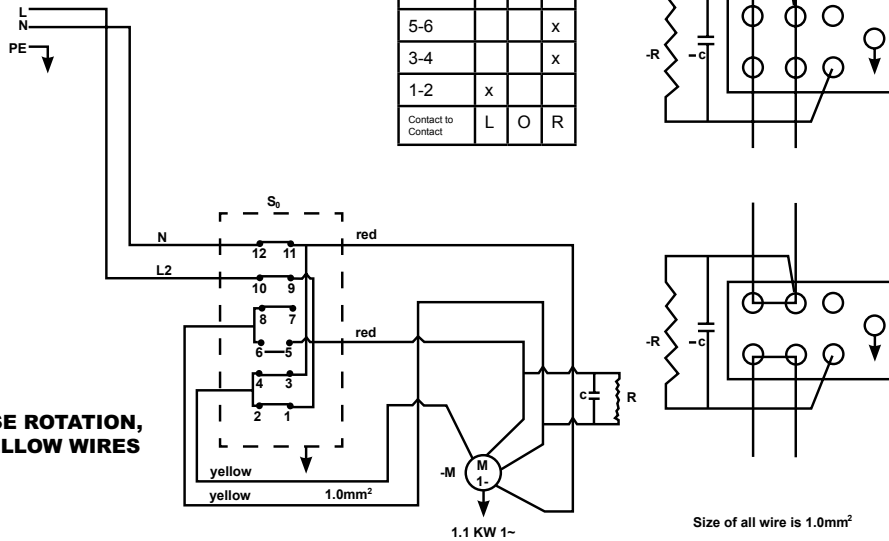

NOTE:
TO REVERSE ROTATION,
SWITCH YELLOW WIRES

Size of all wire is 1.0mm²

6 Lead Motor

110v-1PH

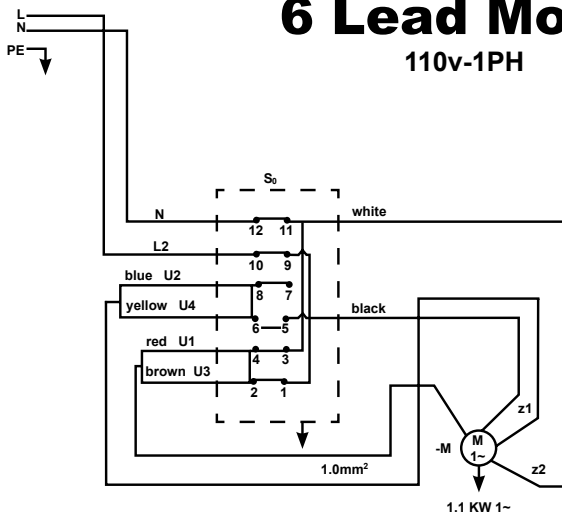

11-2	x		x
9-10	x		x
7-8	x		
5-6			x
3-4			x
1-2	x		
Contact to Contact	L	O	R





Size of all wire is 1.0mm²

12 Trouble Shooting



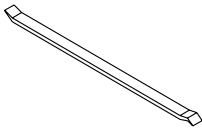

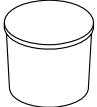
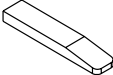
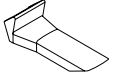
Malfunction	Cause	Possible Remedies
The turntable does not rotate in any direction	<ol style="list-style-type: none"> 1. The electrical supply not plugged in. 2. Incorrect plug connection 3. Electrical tension is incorrect 4. Belt broken 5. Reverser broken 6. Problem with motor 	<ol style="list-style-type: none"> 1. Check the correct insertion of the plug and its connections 2. See 5.4 3. See 5.4 4. Replace belt 5. Replace reverser 6. Replace motor
The turntable rotates only weakly	<ol style="list-style-type: none"> 1. Electrical tension is incorrect 2. Belt loose 	<p>See 5.4</p> <p>Tighten the belt. see11.2</p>
The jaws does not lock the wheel correctly	<ol style="list-style-type: none"> 1. The pneumatic supply has not been connected to the machine 2. Pneumatic supply pressure is too low 3. Pressure regulator closed or incorrectly adjusted 4. Silencer clogged 5. Problem with cylinder 	<ol style="list-style-type: none"> 1. Connect the pneumatic system? 2. Adjust the compress system air pressure. 3. Activate or correct the adjustment of the pressure regulator 4. Clean or replace the silencer 5. Replace the cylinder gaskets
The bead breaker does not have sufficient power to bread the bead	<ol style="list-style-type: none"> 1. The pneumatic supply has not been connected to the machine 2. Pneumatic supply pressure is too low 3. Pressure regulator closed or incorrectly adjusted 4. Silencer clogged 5. Problem with cylinder 	<ol style="list-style-type: none"> 1. Connect the pneumatic system? 2. Adjust the compress system air pressure. 3. Activate or correct the adjustment of the pressure regulator 4. Clean or replace the silencer 5. Replace the cylinder gaskets
Pedals lock out of working position	<ol style="list-style-type: none"> 1. Spring broken 	<ol style="list-style-type: none"> 1. Replace the spring

Other possible malfunctions are principally technical in nature and must be checked and resolved by professionally qualified technicians.

13.1 Accessories Standard

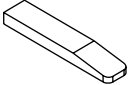
	Tire Tool	1PC
	Lubrication tin ring	1PC
	Lubrication tin	1PC
	Bead lever guard	1PC
	Jaws guards	4PC
	Mounting head guards	1PC
	Brush	1PC

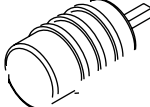
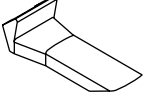
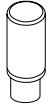
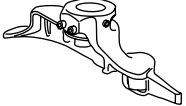
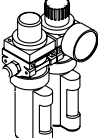
13.2 Accessories Required

	Bead lever guard		Pedal spring
	DIMH		Reversing Switch
	Jaw Protector		Silencer/Muffler
	Steel Duckhead		FRL
	Wheel support		

PARTS MANUAL

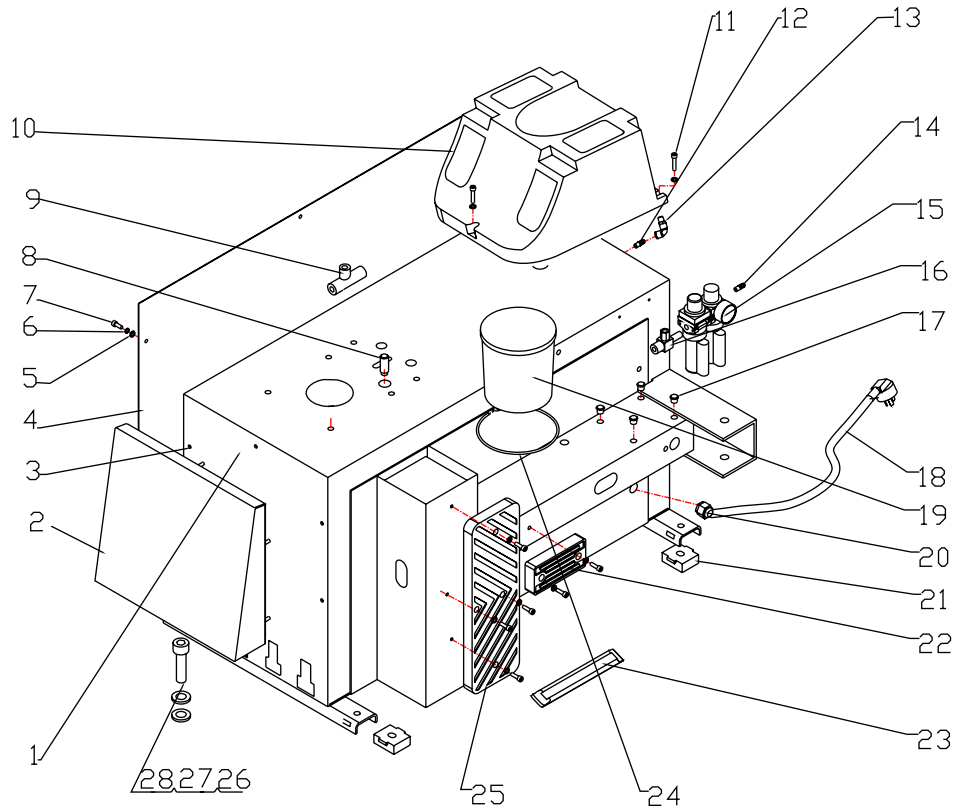

No.	Part No.	Description	Q'ty
1	T260-001	Cabinet	1
2	T260-002	Pedal Guard	1
3	T260-003	Nut M6	5
4	T260-004	Side Cover	1
5	T260-005	Flat Washer f6	21
6	T260-006	Elastic washer f6	6
7	T260-007	Bolt M6×15	6
8	T260-008	Oiling Pipe	1
9	T260-009	Union f8	2
10	T260-010	Toolbox	1
11	T260-011	Bolt M6×20	9
12	T260-012	Union 8-02	1
13	T260-013	Union 8-02	1
14	T260-014	Pagoda Union	1

No.	Part No.	Description	Q'ty
15	T260-015	Distributor of oil and water	1
16	T260-016	Union G1/4	1
17	T260-017	Hole stopperf12	4
18	T260-018	Power Lead	1
19	T260-019	Water Box	1
20	T260-020	Loop	1
21	T260-021	Rubber Foot	4
22	T260-022	Small wheel support	1
23	T260-023	Crowbar	1
24	T260-024	Water Box Holder	1
25	T260-025	Big wheel support	1
26	T260-026	Bolt M0×20	4
27	T260-027	Flat Washerf10	4
28	T260-028	Lock washerf10	4

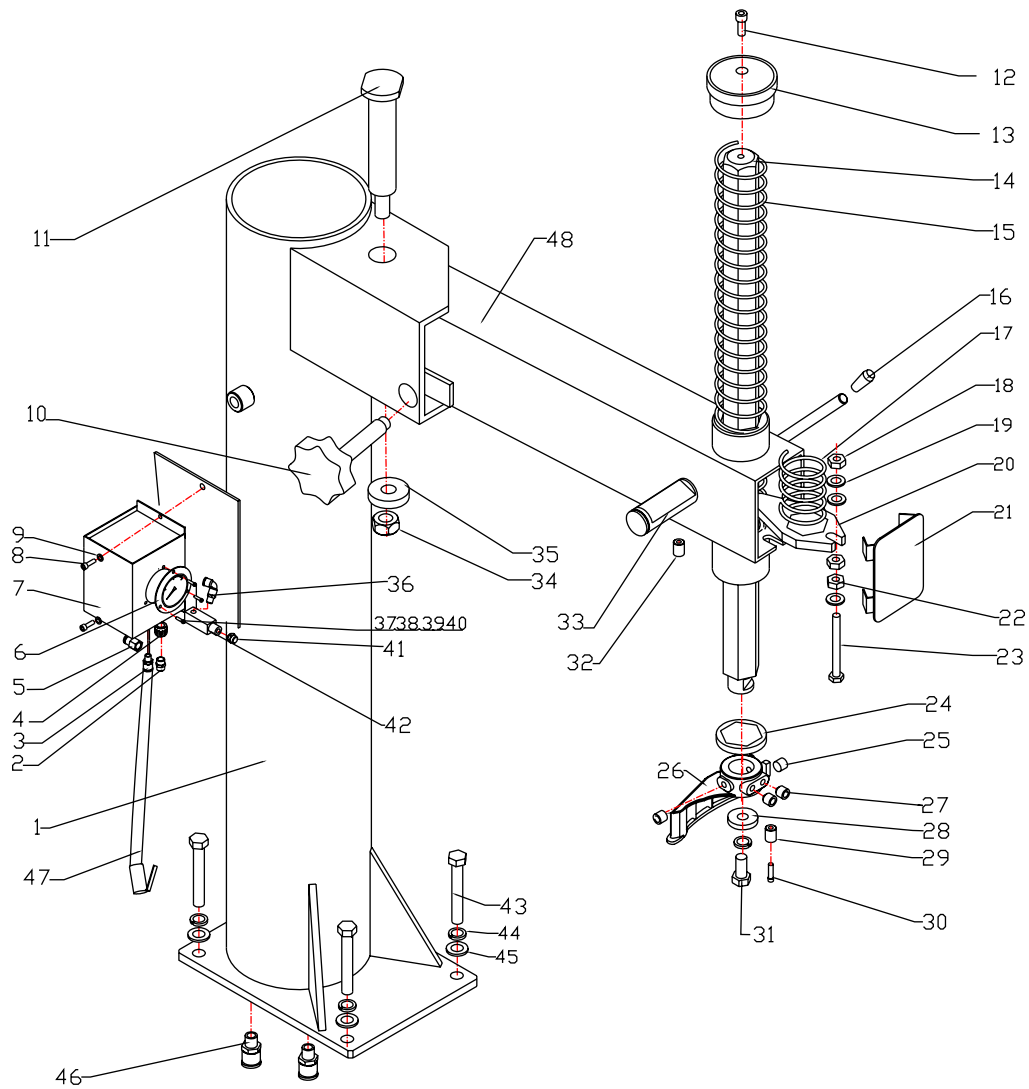

No.	Part No.	Description	Q'ty
1	T260-029	Vertical Arm	1
2	T260-030	Union G1/4	1
3	T260-031	Quick Union 8-01	1
4	T260-032	Placket Nut	1
5	T260-033	Union 8-02	1
6	T260-034	Pressure gauge(f60)	1
7	T260-035	Gauge box	1
8	T260-036	Bolt M6×20	2
9	T260-037	Nut M6	2
10	T260-038	Tightening Wheel	1
11	T260-039	Pivot	1
12	T260-040	Bolt M8×20	1
13	T260-041	Mounting bar cap	1
14	T260-042	Mounting bar	1
15	T260-043	Mounting bar spring	1
16	T260-044	Locking lever knob	1
17	T260-045	Spring	1
18	T260-046	Nut M10	3
19	T260-047	Flat Washer f10	3
20	T260-048	Locked board	1
21	T260-049	Lid	1
22	T260-050	Anti-receding M10	2
23	T260-051	Bolt M10×90	1
24	T260-052	Shock absorber	1

No.	Part No.	Description	Q'ty
25	T260-053	Screw M12×10	2
26	T260-054	Mounting Head	1
27	T260-055	Screw M12×15	2
28	T260-056	Mounting Head washer	1
29	T260-057	Peak Roll	1
30	T260-058	Spring pin	1
31	T260-059	Bolt M12×25	1
32	T260-060	Screw M8×15	1
33	T260-061	Locked shaft	1
34	T260-062	Nut M16	1
35	T260-063	Washer	1
36	T260-064	Union 8-01	1
37	T260-065	Bolt M4×10	5
38	T260-066	Flat Washer f4	5
39	T260-067	Elastic washer f4	5
40	T260-068	Nut M4	2
41	T260-069	Deflation button	1
42	T260-070	Deflation valve	1
43	T260-071	Bolt M12×80	5
44	T260-072	Elastic washer f12	5
45	T260-073	Flat Washer f12	5
46	T260-074	Quick Union 10-03	2
47	T260-075	Collet rubber pipe	1
48	T260-076	Horizontal Arm	1

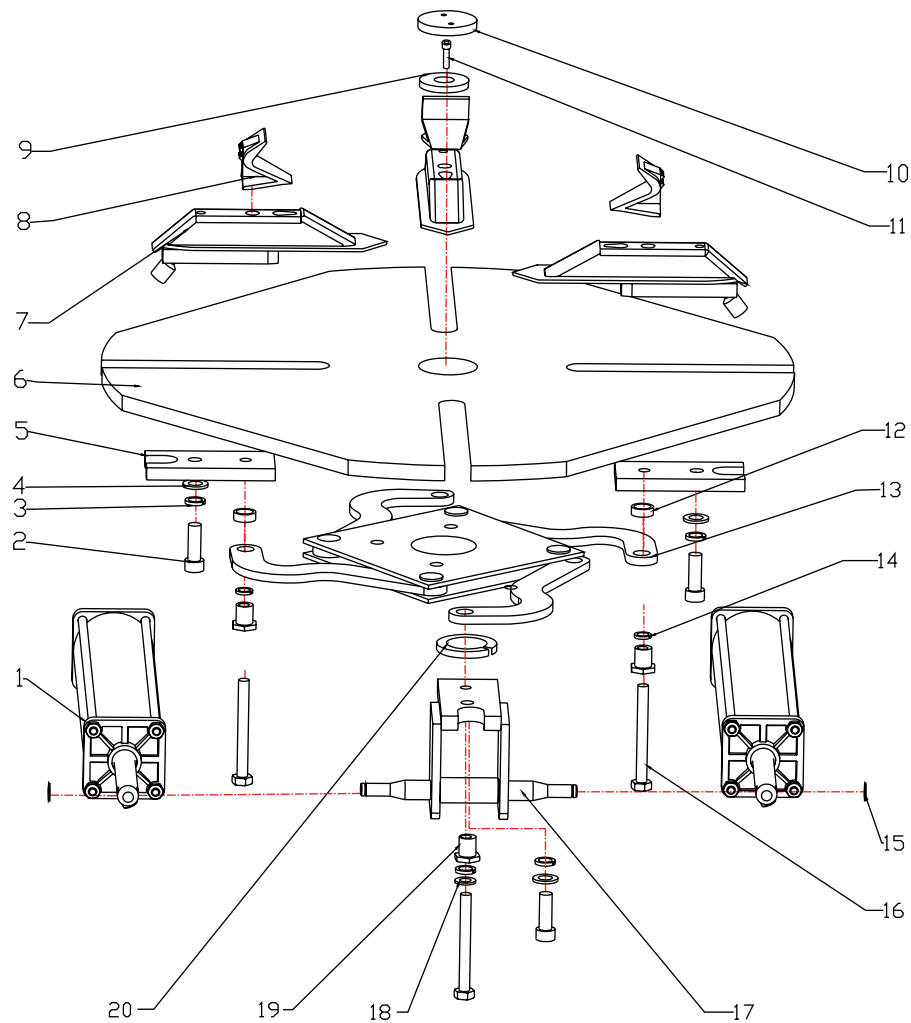

No.	Part No.	Description	Q'ty
1	T260-077	Small Cylinder assembly	2
2	T260-078	Bolt M12×45	4
3	T260-079	Flat Washer f12	4
4	T260-080	Growing washer f12	4
5	T260-081	Saddle	2
6	T260-082	Turntable	1
7	T260-083	Slide	4
8	T260-084	Clamp	4
9	T260-085	Washer	1
10	T260-086	Turntable Cap	1

No.	Part No.	Description	Q'ty
11	T260-087	Bolt M16×45	1
12	T260-088	Bushing	4
13	T260-089	Turntable Flange	1
14	T260-090	Lock washer f10	4
15	T260-091	Ring f12	2
16	T260-092	Bolt M10×95	4
17	T260-093	Small Cylinder bracket	2
18	T260-094	Flat Washer f10	4
19	T260-095	Sleeve	4
20	T260-096	Ring f62	1

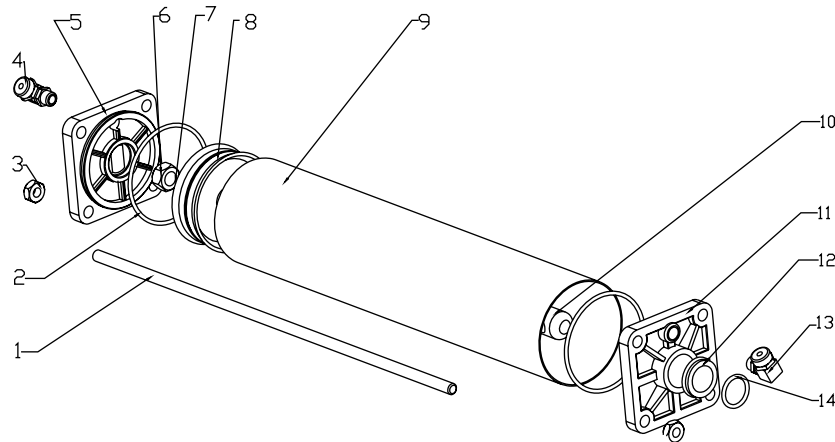

No.	Part No.	Description	Q'ty
1	T260-097	Small cylinder Lever	8
2	T260-098	O Ring f70×2.65	4
3	T260-099	Anti-receding M8	16
4	T260-100	Union 8-M10×1	3
5	T260-101	Rear cover of cylinder	2
6	T260-102	Flat Washerf12	2
7	T260-103	Nut M12	2

No.	Part No.	Description	Q'ty
8	T260-104	Piston	2
9	T260-105	Cylinder Body	2
10	T260-106	Cylinder shaft	2
11	T260-107	Front cover of cylinder	2
12	T260-108	Y Ring28×20×5	2
13	T260-109	Union	1
14	T260-110	O Ring20×2.65	2

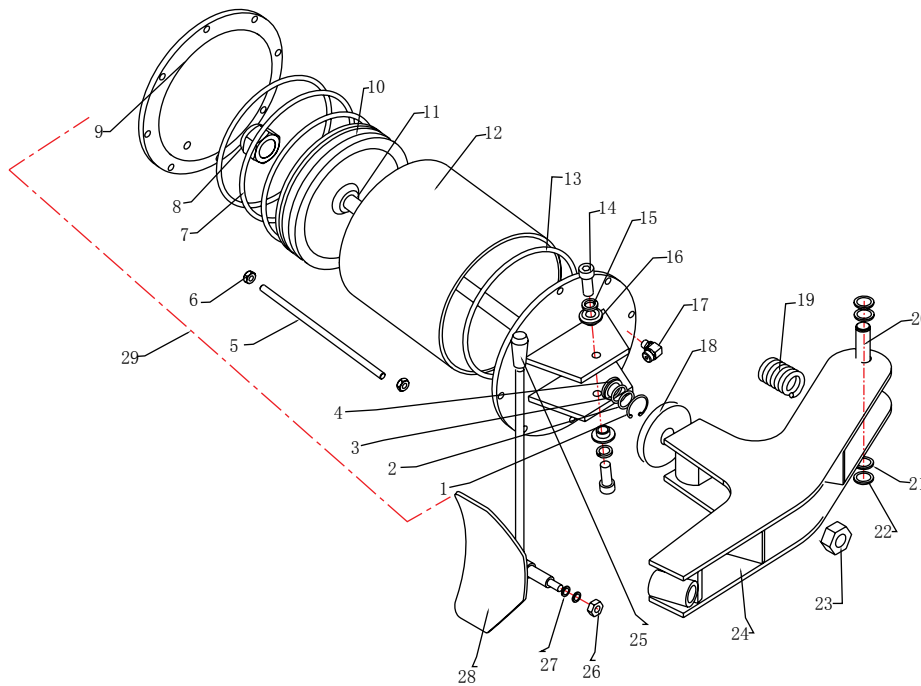

28

No.	Part No.	Description	Qty
1	T260-111	Ring f28	1
2	T260-112	O Ringf22×2.4	2
3	T260-113	O Ringf16×2.4	1
4	T260-114	Y Ring Y28×18×7	1
5	T260-115	Fixed lever	8
6	T260-116	Anti-receding M8	16
7	T260-117	O Ringf180×5.7	2
8	T260-118	Anti-receding M12	1
9	T260-119	Rear cover of cylinder	1
10	T260-120	Piston	1
11	T260-121	Piston lever	1
12	T260-122	Cylinder Body	1
13	T260-123	O Ringf180×3.1	2
14	T260-124	Bolt M12×30	2
15	T260-125	Lock washerf12	2

No.	Part No.	Description	Qty
16	T260-126	Cylinder bush	2
17	T260-127	Union 8-M10×1	2
18	T260-128	Cushion	1
19	T260-129	Spring	1
20	T260-130	Pivot	1
21	T260-131	Flat Washer f16	2
22	T260-132	Ring f16	2
23	T260-131	Anti-receding M16	1
24	T260-132	Arm	1
25	T260-133	Sheath f12	1
26	T260-134	Anti-receding M12	1
27	T260-135	Flat Washer f12	1
28	T260-136	Bead Breaker	1
29	T260-137	Big cylinder assembly	1

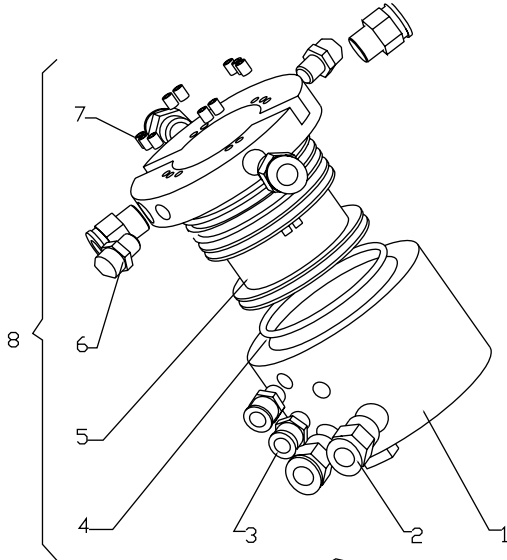

No.	Part No.	Description	Q'ty
1	T260-138	Distributor outside	1
2	T260-139	Quick Union10-03	2
3	T260-140	Union 8-01	2
4	T260-141	O Ring 70×3.1	4
5	T260-142	Distributor inside	1
6	T260-143	Quick Union 10-02	4
7	T260-144	Screw M5×6	10
8	T260-145	Distributor assembly	1

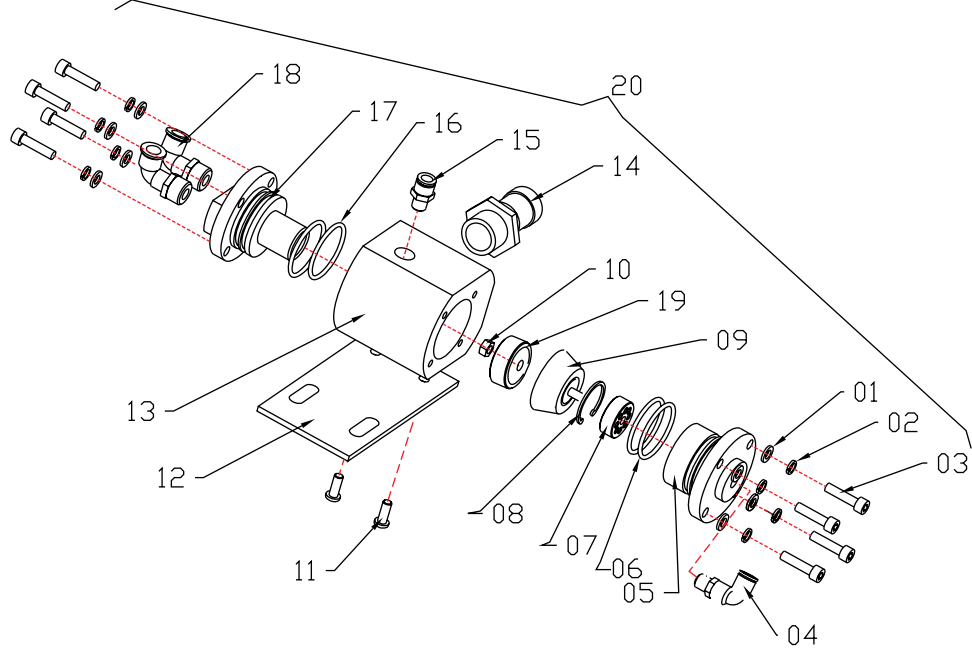

No.	Part No.	Description	Q'ty
1	T260-146	Flat Washer f6	8
2	T260-147	Elastic washer f6	8
3	T260-148	Bolt M6×20	8
4	T260-149	Union 8-01	1
5	T260-150	Right cover	1
6	T260-151	O Ring f40×2.65	2
7	T260-152	Seal washer	1
8	T260-153	Ring	1
9	T260-154	Piston with seal	1
10	T260-155	Nut M6	1

No.	Part No.	Description	Q'ty
11	T260-156	Bolt M6×16	2
12	T260-157	Fixed bracket	1
13	T260-158	Valve body	1
14	T260-159	Connector	1
15	T260-160	Quick Union 8-03	1
16	T260-161	O Ring f40×2.65	2
17	T260-162	Left cover	1
18	T260-163	Union 14-03	2
19	T260-164	Seal	1
20	T260-165	Distributor valve assembly	1

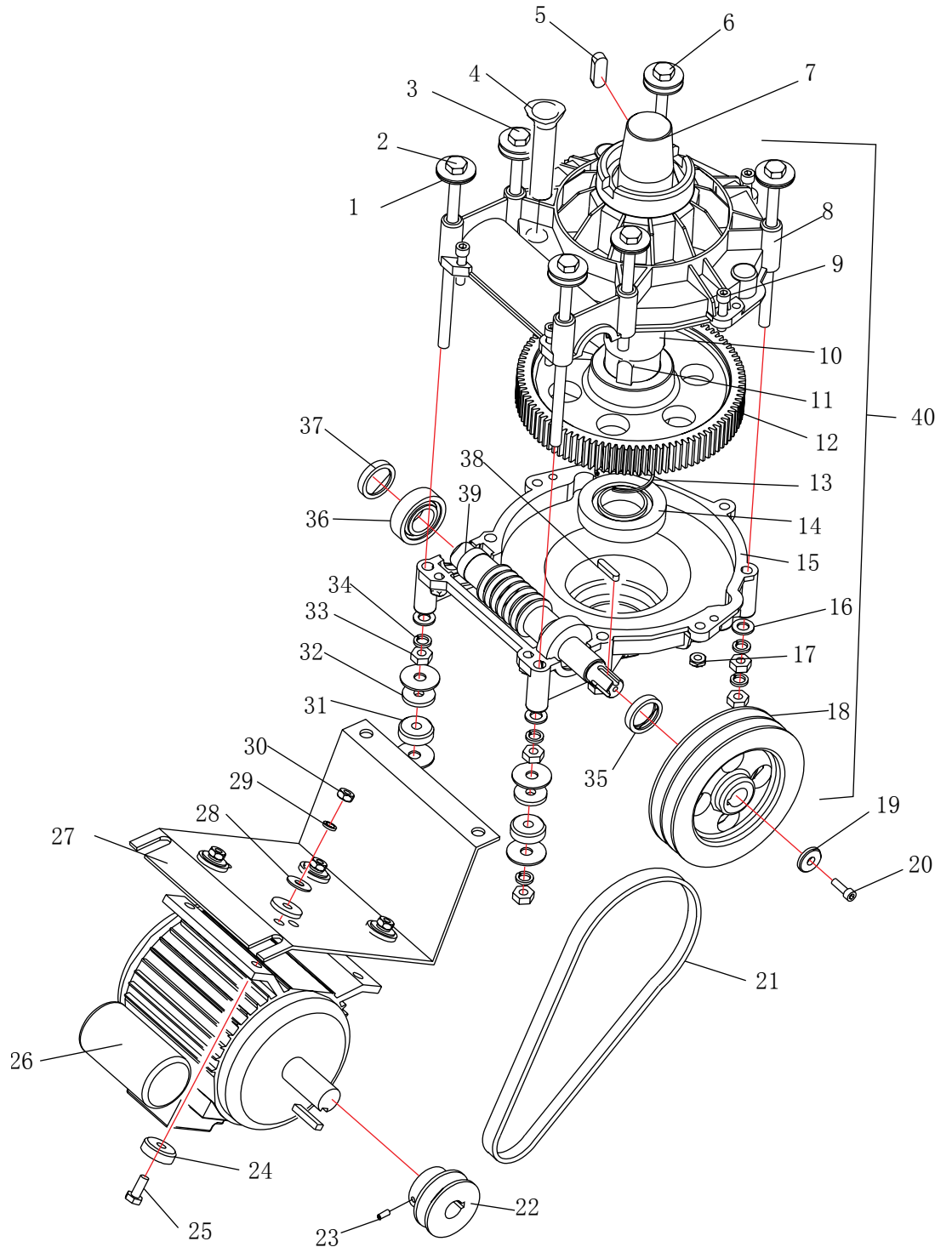

No.	Part No.	Description	Q'ty
1	T260-166	Washer	16
2	T260-167	Bolt M10×160	2
3	T260-168	Bolt M10×180	2
4	T260-169	Oiling connector	1
5	T260-170	Fixing pin	1
6	T260-171	Bolt M10×210	2
7	T260-172	Wormgear shaft	1
8	T260-173	Upper cover of gearbox	1
9	T260-174	Bolt	5
10	T260-175	Bearing	1
11	T260-176	Fixing pin	1
12	T260-177	Wormgear	1
13	T260-178	Ring	1
14	T260-179	Bearing	1
15	T260-180	Lower cover of gearbox	1
16	T260-181	Flat washer	10
17	T260-181	Nut	5
18	T260-182	Big pulley	1
19	T260-183	Washer	1
20	T260-184	Bolt	1

No.	Part No.	Description	Q'ty
21	T260-185	Belt	1
22	T260-186	Motor pulley	1
23	T260-187	Screw	1
24	T260-188	Bolt	4
25	T260-189	Motor shock absorber	4
26	T260-190	Motor	1
27	T260-191	Motor cradle	1
28	T260-192	Flat washer	4
29	T260-193	Spring washer	4
30	T260-194	Nut	4
31	T260-195	Motor shock absorber	2
32	T260-196	Motor shock absorber	6
33	T260-197	Nut	12
34	T260-198	Grower washer	10
35	T260-199	Oil seal	1
36	T260-200	Bearing	2
37	T260-201	Seal	1
38	T260-202	Fixing pin	1
39	T260-203	Worm	1
40	T260-204	Gearbox Assembly	1

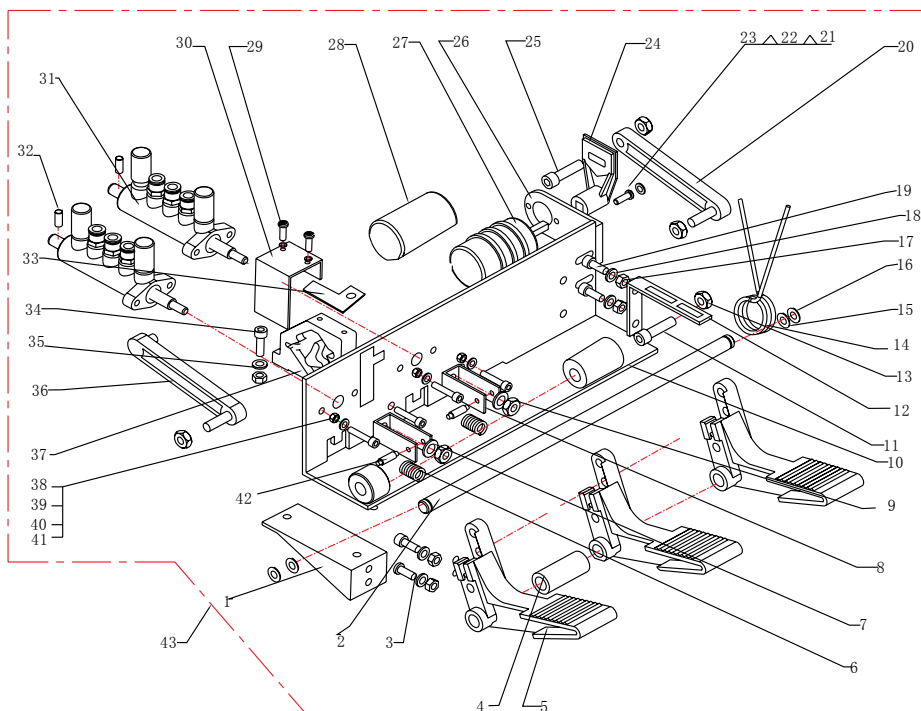

No.	Part No.	Description	Q'ty
1	T260-205	Bracket of double cam	1
2	T260-206	Pin	1
3	T260-207	Bolt	1
4	T260-208	Spacer	1
5	T260-209	Pedal	3
6	T260-210	Pedal Spring	2
7	T260-211	Valve lever plate	2
8	T260-212	Anti-receding nut	6
9	T260-213	Washer	2
10	T260-214	Bracket of pedal	1
11	T260-215	Bolt	1
12	T260-216	Confining Slab	1
13	T260-217	Spring	1
14	T260-218	Nut	2
15	T260-219	Flat Washer	2
16	T260-220	Ring	2
17	T260-221	Nut	8
18	T260-222	Flat Washer	6
19	T260-223	Bolt	5
20	T260-224	Reverser Connecting Rod	1
21	T260-225	Bolt	1
22	T260-226	Flat Washer	

No.	Part No.	Description	Q'ty
23	T260-227	Elastic washer	1
24	T260-228	Reverse Lever	1
25	T260-229	Bolt	1
26	T260-230	Reverser support	1
27	T260-231	Reverser	1
28	T260-232	Reverser Guard	1
29	T260-233	Bolt	2
30	T260-234	Shield	1
31	T260-235	Valve Assembly	2
32	T260-236	Pin	1
33	T260-237	Leaf Spring	1
34	T260-238	Bolt	2
35	T260-239	Elastic washer	6
36	T260-240	Connecting Rod	1
37	T260-241	Double Cam	1
38	T260-242	Bolt	4
39	T260-243	Flat Washer	4
40	T260-244	Elastic washer	4
41	T260-245	Nut	4
42	T260-246	Pin	2
43	T260-247	Pedal 1 assembly	1

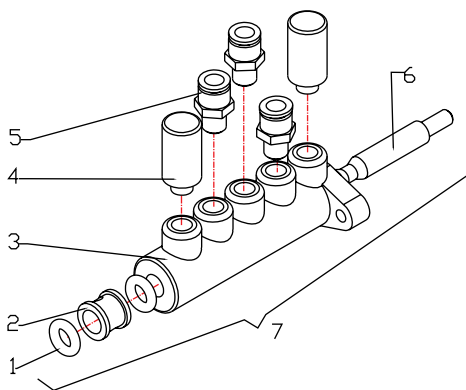

No.	Part No.	Description	Q'ty
1	T260-248	O Ring 17.4x4	12
2	T260-249	Spacer of valve	10
3	T260-250	Distribution valve	2
4	T260-251	Silencer	4
5	T260-252	Quick Union 8-01	6
6	T260-253	Valve lever	2
7	T260-254	Valve Assembly	1

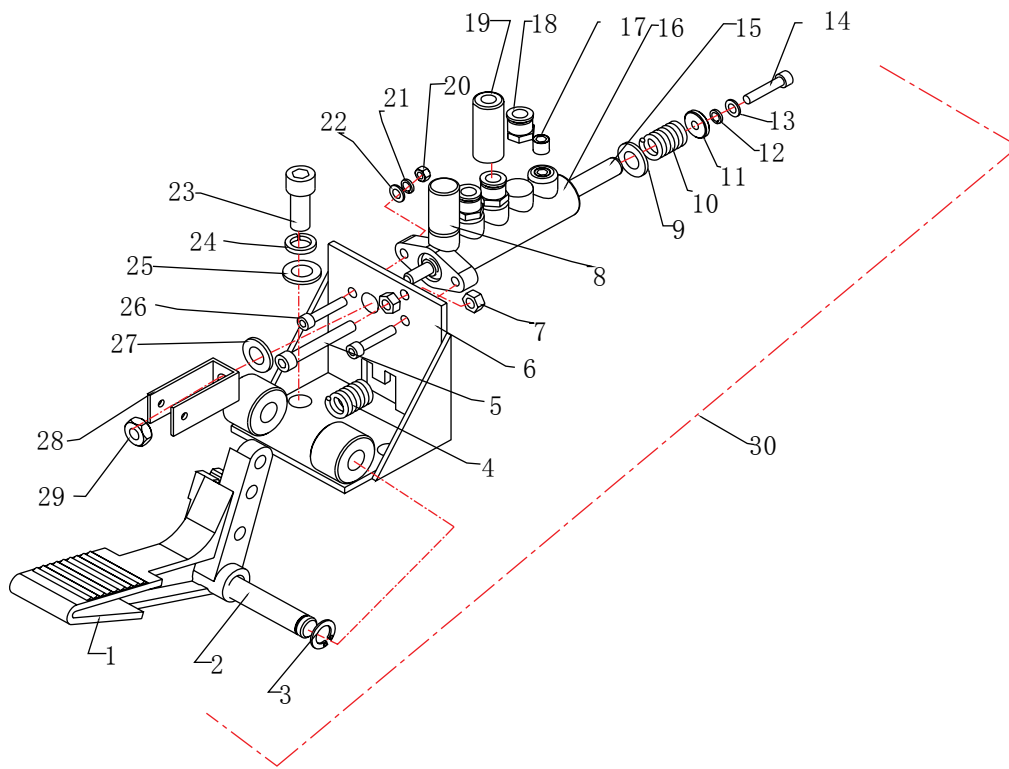

No.	Part No.	Description	Q'ty
1	T260-255	Pedal	1
2	T260-256	Pin	1
3	T260-257	Ring	2
4	T260-258	Pedal Spring	1
5	T260-259	Bolt M6×45	1
6	T260-260	Bolt M5×25	1
7	T260-261	Nut M6	2
8	T260-262	Silencer G1/8	1
9	T260-263	Washer	1
10	T260-264	Spring	1
11	T260-265	Washer	1
12	T260-266	Flat Washer f5	1
13	T260-267	Elastic washer f5	1
14	T260-268	Bolt M5×10	1
15	T260-269	Valve lever	1

No.	Part No.	Description	Q'ty
16	T260-270	Valve Assembly	1
17	T260-271	Stopper G1/8	1
18	T260-272	Quick Union 8-01	3
19	T260-273	Unilateral valve	1
20	T260-274	Nut M5	2
21	T260-275	Elastic washerf5	2
22	T260-276	Flat Washer f5	2
23	T260-277	Bolt M10×25	2
24	T260-278	Elastic washerf10	2
25	T260-279	Flat Washer f10	2
26	T260-280	Bolt M5×25	2
27	T260-281	Washer	1
28	T260-282	Valve lever plate	1
29	T260-283	Anti-receding M8	1
30	T260-284	Pedal 2 assembly	1

Warranty Activation Form

ATTENTION: MAIL TODAY TO ACTIVATE YOUR WARRANTY !

WARRANTY IS NON-TRANSFERABLE

Company Name: _____

Owner / Shop Manager: _____

Address: _____

Phone: () _____ Fax: () _____ Cell: () _____

City/State/Province/Zip: _____

E-mail: _____

PSE TC-260

MODEL NO:	PSE TC-260
CAPACITY:	
SERIAL NO:	
DATE:	



Purchased From: _____ Purchase Date: _____

Address: _____

City: _____ State: _____ Zip: _____

Office Phone: () _____ Cell Phone: () _____

FOLD IN HALF, TAPE TOP, APPLY STAMP & MAIL !!!

Pro-Series Equipment
P.O. Box 734
Franklin, IN

Pro-Series Equipment
P.O. Box 734
Franklin, Indiana
ATTN.: Warranty Dept.

Place
Stamp
Here