

INSTALLATION MANUAL & OPERATION INSTRUCTIONS

MOTORCYCLE LIFT PSE TCML / PSE TCMLW

PSE TCML (24" x 110" Lift Table)

PSE TCMLW (48" x 110" Lift Table)

Heavy-Duty Motorcycle Lift w/ Service Jack
1,500 LB. Capacity

LIFT FEATURES:

- Drop Tail Design
- 7 Position Safety Locking System
- Includes FREE Service Jack
- Includes FREE Adjustable Front Extension!
- Includes FREE Front Wheel Vise & Front Wheel Stop!
- **1 YEAR WARRANTY**
- More Lifts Available!



Thank You For Your Purchase!

We reserve the right to make changes in specifications without notice and without making changes retroactive.



To help prevent possible serious injury and / or death, Carefully read this manual and review all warnings and instructions before use!

PRO-SERIES

Equipment

www.ProSeriesEquipment.com

P.O. Box 734
Franklin, Indiana 46131
1-800-708-2988

Email: Sales@ProSeriesEquipment.com

Model No.:	
Capacity:	1,500 lbs.
Serial No.:	
Installation Date:	
Distributor:	
Dist. Phone Number:	
Installer:	
Installer Phone Number:	



(Catalog Number: PSE TCML / PSE TCMLW)

31.1 Intended Use	
	1.2 Dimension Diagram.....	4
	1.3 Product Specifications.....	5
62.1 Level of Danger	
	2.2 Hazards / Warnings.....	6
	2.3 Safety Instructions.....	7
4.1	Tools For Installation.....	10
	4.3 Determine Proper Lift Location	10
	4.4 Unpacking & Setup	10
	4.5 Vise Installation	11
	4.6 Side Extension Installation	12
15 5.1 Check The Safety Lock Assembly	
	5.2 To Position, Lifting And Lowering Vehicles and Equipment on Lift.....	15-16
15 6.0 Maintenance Schedule	
	6.1 Daily Operation Precheck	16
	6.2 Weekly Maintenance	16
6.3	6 Month Annual Maintenance	16
	6.4 Pneumatic Maintenance: PSE Authorized Technician	16
	7.1 Parts Breakdown.....	17

PRO SERIES EQUIPMENT

P.O. BOX 734 FRANKLIN, INDIANA 46131

Web: www.ProSeriesEquipment.com

E-mail: Sales@ProSeriesEquipment.com

Thank you for purchasing this Pro Series Equipment lift! This machine has been constructed using some of the highest manufacturing standards of today. This manual has been made in order to supply the owner as well as the user with basic instructions for the correct installation and use of this lift. The owner of this equipment is responsible to ensure that this lift is installed and operated using the guidelines set forth in this manual, failure to comply may result in voiding of this equipment's warranty.

Read this guide thoroughly before installing or using the machine. This guide contains the instructions for installation, use and maintenance of the PSE TCML & PSE TCMLW Motorcycle Lift.

This machine is operated by pressurized air from an air compressor (not included) to the lift, which delivers the pressure to a heavy air cylinder at the bottom of the platform to provide lifting pressure. This lift was designed for the sole purpose of performing service, repairing and inspection on small equipment such as Motorcycles, ATV's & Lawn Mowers. Any other use not described is to be considered as improper use, and thus it will be under the whole responsibility of the owner/operator and not covered under any warranties or damage that may occur.

Follow the instructions in this guide carefully to ensure proper function, efficiency and a long operational life. Keep this guide as well as all the supplied technical literature in a safe place close to the lift so that operators are able to consult it whenever necessary. The technical literature is an integral part of the machine and it must always stay with the product, even in case of sale.

Follow the directions given by this guide with the utmost attention: the seller is not responsible for any damage due to negligence and non-observance of the herewith-contained instructions. The non-observance of herewith-contained instructions will automatically involve the immediate lapse of warranty.

1.1 Intended Use

This lift must only be used in the manner for which it is expressly designed. Any other use of this equipment not described in this manual is dangerous and should be avoided. The seller cannot be held responsible for any damage or injury caused by the improper use or by the non-observance of the instructions within this manual:

- ***The lift must be installed using the specifications in this manual.***
- ***The owner and all operators must be familiar with all of the operational guidelines laid out within this manual.***
- ***The technical literature is an integral part of the machine. Read this guide carefully before installing or operating this machine, important safety rules for installation, operation and maintenance are enclosed.***

**KEEP THIS AS WELL AS ALL OTHER TECHNICAL LITERATURE
IN A SAFE PLACE AND CONSULT WHENEVER NECESSARY!**

1.2 Dimensional Diagram

DIMENSIONS PSE TCML & PSE TCMLW

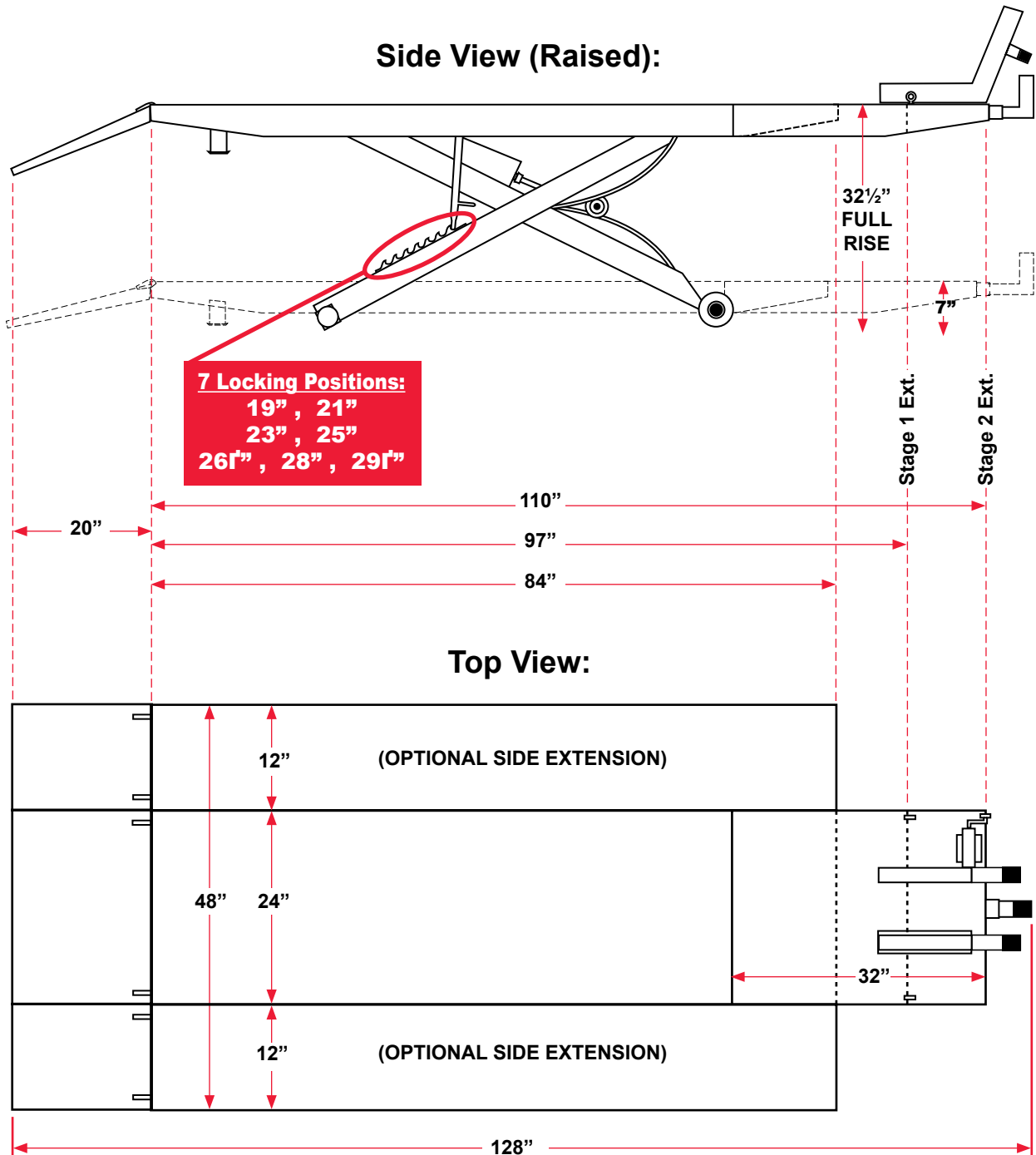

1.3 Product Specifications

The required air supply for the PSE TCML & PSE TCMLW is the 90 - 110 psi, this lift does not come with its own air compressor and this must be provided.

PSE TCML & PSE TCMLW MOTORCYCLE LIFT	
<i>Weight Lifting Capacity</i>	1,500 Pounds
<i>Lift Height</i>	32½" Full Rise
<i>Working Condition Temperature</i>	41° F - 104° F
<i>Working Condition Humidity</i>	30% - 80%
<i>Transport / Storage Temperatures</i>	-13° F - 131° F
<i>Air Requirements</i>	90 - 110 psi

2.1 Level of Danger

Whenever you find the following warning sign in this guide, pay the utmost attention and follow the relevant safety rules.



ATTENTION: Read the following directions with the utmost attention. Non-observance of described procedures/practices can cause serious damages to bystanders.

2.2 HAZARDS / WARNINGS



IN THE EVENT THE RAISED EQUIPMENT FALLS FROM THE LIFT, RUN AWAY TO A SAFE DISTANCE.



DO NOT OPERATE A LIFT WITH PEOPLE ON IT.



DO NOT STAND UNDER EQUIPMENT ON THE LIFT WHILE LIFT IS OPERATING. DEATH OR SERIOUS INJURY MAY OCCUR.



IF AROUND ELECTRICAL COMPONENTS, ELECTRICAL SHOCK MAY OCCUR.



DO NOT LIFT ONE SIDE OF THE EQUIPMENT. POSSIBILITY OF EQUIPMENT OVERTURN AND/OR DAMAGE TO LIFT MAY HAPPEN.



AUTHORIZED PERSONNEL ONLY IN LIFT AREA.



DO NOT PLACE ANY POLES UNDER EQUIPMENT AND LOWER IT TO DISMANTLE THE PART FROM THE RAISED EQUIPMENT.

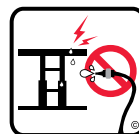

DO NOT SPRAY WATER DIRECTLY ONTO LIFT.



DO NOT MODIFY ANY SAFETY SYSTEMS OF THIS LIFT. IF SAFETY DEVICE MALFUNCTIONS, SERIOUS ACCIDENT MAY OCCUR.

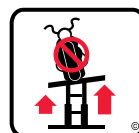

STOP RAISING LIFT WHEN IMBALANCE IS DETECTED WHILE RASING EQUIPMENT



DO NOT EXCESSIVELY SHAKE RAISED EQUIPMENT. DANGER OF EQUIPMENT FALLING FROM LIFT MAY OCCUR.



DO NOT OPERATE LIFT WHEN HYDRAULIC OIL LEAK IS DETECTED IN THE LIFT AREA



DO NOT PLACE FEET, HANDS OR ANY PART OF BODY UNDER ANY MOVING PART OF LIFT WHILE RAISING OR LOWERING.

2.3 Safety Instructions

The messages and pictures shown are generic in nature and are meant to generally represent hazards common to all automotive lifts regardless of specific style.

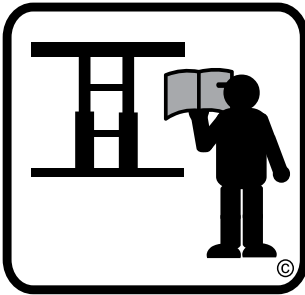

**READ OPERATING AND SAFETY
MANUALS BEFORE USING LIFT!**



DO NOT OPERATE A DAMAGED LIFT!



**PROPER MAINTENANCE AND INSPECTION
ARE NECESSARY FOR SAFE OPERATION DAILY!**



**LIFT TO BE USED BY
TRAINED OPERATOR ONLY!**



CAREFULLY READ ALL INSTRUCTIONS BEFORE ATTEMPTING TO INSTALL OR OPERATE THIS LIFT!

Failure to follow all instructions listed in the following pages may result in electric shock, fire, and / or serious injury.

1. Keep work area clean and well lit. Cluttered, wet, and dark work areas invite accidents.
3. Keep bystanders, children, and visitors away while operating this lift. Distractions can cause you to lose control of the equipment.
4. Stay alert watch what you are doing, and use common sense when operating this lift. **DO NOT** use this lift while fatigued or under the influence of drugs, alcohol, or medication. A moment of inattention while operating this lift may result in serious personal injury.
5. **RISK OF ENTANGLEMENT!** Dress properly. **DO NOT** wear loose clothing or jewelry. Contain long hair. Keep your hair, clothing, and gloves away from moving parts. Loose clothes, jewelry, or long hair can be caught in moving parts.
6. Remove adjusting keys or wrenches before using this lift. A wrench or a key that is left attached to a moving part of the lift can cause damage to the lift or serious accidents.
7. **DO NOT** overreach. Keep proper footing and balance at all times. Proper footing and balance enables better control of this lift in unexpected circumstances.
8. Use safety equipment. Always wear OSHA approved safety impact eye goggles underneath a full face shield.
9. Only trained and authorized personnel should position equipment for lifting and operate this lift.
10. Use clamps (not included) or other practical ways to secure and support the work piece to a stable platform. Holding the work by hand or against your body is unstable and may lead to loss of control. Always use Tie Down Eyelets provided for securing equipment.
11. Check for misalignment or binding of moving parts, breakage of parts, and any other condition that may affect the equipment's operation. If damaged, have the equipment serviced before using. Many accidents are caused by poorly maintained equipment.
12. Use only accessories that are recommended by the manufacturer for your model. Accessories that may be suitable for one lift may become hazardous when used on another lift.
13. Service must be performed only by PSE authorized qualified repair personnel. Service or maintenance performed by unqualified personnel could result in a risk of injury.
14. When servicing, use only identical replacement parts. Follow instructions in the "INSPECTION, MAINTENANCE, AND CLEANING" section of this manual. Use of unauthorized parts or failure to follow maintenance instructions may create a risk of electric shock or injury.
15. **DANGER!** Make sure you know the weight of the equipment you are going to lift before using the Lift. Do not exceed the maximum lift capacity (1,500 pounds) for the Lift. Overloading the Lift could cause personal injury and / or property damage. Be aware of dynamic loading! If a weight suddenly falls onto the Lift. It may create for a brief instant an excess load which may result in personal injury and / or damage to the equipment and Lift. This Lift should be loaded only in the center of the Lift itself, from front to rear and in line with the clamping vise.
16. Use the Lift only in well ventilated areas. Carbon monoxide exhausted from running equipment engines is a colorless, odorless fume that, if inhaled, can cause serious personal injury.
17. Make sure to read and understand all instructions and safety precautions as outlined in the manufacturer's manual for the equipment you are lifting. Always use the manufacturer's recommended lifting points.
18. **DO NOT** use the Lift on any asphalt surface. Make sure the Lift used on a dry, oil/grease free, flat, level, concrete surface capable of supporting the weight of the Lift. **DO NOT** use the Lift on concrete expansion seams or on cracked, defective concrete.
19. Always examine the Lift for structural cracks, bends, damage to the hoses, and any other condition that may affect the safe operation of the Lift. **DO NOT** use the Lift even if minor damage is detected.
20. Prior to beginning a job, make sure the Safety Lock Assembly and its Safety Catches are in the proper position. Never work underneath equipment without using additional safety support devices such as tri-pod stands to support the Lift.
21. Always keep hands, fingers, and feet away from the moving parts of the Lift when applying or releasing a load. Remain clear of the Lift when raising or lowering equipment.
22. Use extreme caution when applying or releasing a load. Never allow the load to suddenly release. Slowly and carefully apply and release the load the Air Foot Pedal.
23. Never leave the Lift unattended when the Lift is loaded.
24. Never drive equipment onto or off of the Lift make sure the Lift is fully lowered.
 - Never lift equipment with anyone inside it. **DO NOT** allow others in the lift area while operation the Lift. **DO NOT** allow anyone to ride on the Lift while it is being raised or lowered. **DO NOT** ride any equipment on the lift, they should be pushed onto the lift without a passenger.
25. **DO NOT** use the Lift as a permanent stand for equipment. Use the Lift only while making repairs. Then, immediately remove the equipment from the Lift.
26. Before lowering the Lift, make sure tool trays, stands, and all other tools and equipment are removed from under the equipment and the Lift.
27. **DO NOT** allow tearing the warning labels or other labels off the lift

The warnings, precautions, and instructions discussed in this manual cannot cover all possible conditions and situations that may occur. The operator must understand that common sense and caution are factors which cannot be built into this product, but must be supplied by the operator.



ONLY AFTER CAREFULLY READING ALL OF THE PRECEDING SAFETY WARNINGS SHOULD YOU ATTEMPT TO INSTALL OR OPERATE THIS LIFT!

Improper installation or operation can cause injury or damage!

1. **Read this installation and operation manual in its entirety before attempting to install the lift.** Manufacturer or Distributor assumes no responsibility for loss or damage of any kind, expressed or implied, resulting from improper installation or use of this lift. Always use a Authorized PSE professional installer.
2. All persons using this equipment must be responsible, qualified, and carefully follow the operation and safety guidelines contained in this manual.
3. A level floor is required for proper lift installation and operation.
4. **DO NOT** install this lift on any asphalt surface. Only on concrete surface a minimum of 6" thick and 3,000 psi tensile strength with steel or fiber mesh reinforcement.
5. **DO NOT** install this lift over concrete expansion joints or cracks. (Check with your building architect.)
6. **DO NOT** install this lift on an upper floor without written authorization from your building architect. Should only be installed on a basement floor.
7. **DO NOT** attempt to lift only part of the equipment. This lift is intended to raise the entire body of the equipment only.
8. **NEVER lift any persons or equipment containing persons.** This lift is designed to lift empty equipment only.

4.0 Installation

4.0 READ THIS BEFORE INSTALLING THE LIFT

Improper installation can cause injury or damage!

1. **Read this installation and operation manual in its entirety before attempting to install the lift.** Manufacturer or Distributor assumes no responsibility for loss or damage of any kind, expressed or implied, resulting from improper installation or use of this lift. Always use a PSE authorized professional installer.
2. All persons using this equipment must be responsible, qualified, and carefully follow the operation and safety guidelines contained in this manual.
3. A level floor is required for proper lift installation and operation.
4. **DO NOT** attempt to lift only part of a load. This lift is intended to raise the entire load only. This will bend the table/cause damage and void the warranty.
5. **NEVER lift any persons or equipment containing persons.** This lift is designed to lift empty equipment only.

4.1 TOOLS FOR INSTALLATION

Rubber Hammer
Sockets and Open End Wrenches
Ratchet Driver
Vice Grips

4.2 ASSEMBLY INSTRUCTIONS

NOTE: For additional references to the parts listed in the following pages, refer to the Assembly Diagrams on pages 11 - 13.

4.3 Determine The Proper Lift Location:

1. DO not use the Lift on any asphalt surface. Make sure the Lift is used on a dry, oil/grease free, flat, level, concrete surface capable of supporting the weight of the Lift and the equipment. Do not use the Lift on concrete expansion seams or on cracked, defective concrete.
2. Make sure to check the desired location for possible obstructions such as a low ceiling, overhead lines, adequate working area, access ways, exits, etc.

4.4 Unpacking & Setup

1. Open the shipping container, then remove the Ramp and shipping boards out of the packaging.
2. **CAREFULLY TURN TABLE UPRIGHT INTO OPERATING POSITION BEFORE REMOVING THE SHIPPING WIRE THE CABLE RESTRAINT FROM SCISSOR MECHANISM.**
3. **MAKE SURE THAT THE ROLLER GUIDES CONNECTED TO THE CYLINDER ARE ON THEIR TRACKS CORRECTLY BEFORE RAISING THE LIFT!**
4. Connect foot-operated air valve to 90-110 psi air supply. The lift may be damaged and/or personal injury may result if the pressure exceeds the maximum psi rating.
5. Stand clear of lift table, and depress the UP side of the foot valve to raise the Table.
6. To lower table, raise lift and then lift the Safety Lock Bar from Safety Latch and lower to next position or to the floor.
7. Place Dropout Cover over Dropout opening.
8. Insert Ramp Mounting Pins into the holes at the end of the table in places to mount the approach ramp.
9. The Safety Lock Bar can be held up by attaching it to the Safety Lock Bar Clip underneath the Table Assembly.

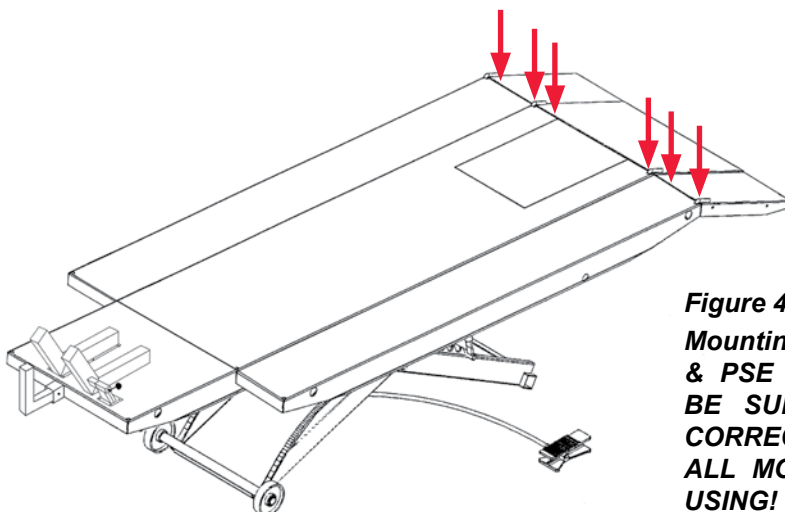

Figure 4.1
Mounting points for the PSE TCML & PSE TCMLW Approach Ramps. BE SURE APPROACH RAMP IS CORRECTLY INSTALLED INTO ALL MOUNTING POINTS BEFORE USING!

4.0 Installation

4.5 VISE INSTALLATION AND EYE BOLTS

The Front Wheel Clamp mounts directly onto the front of either the Table Assembly or the Front Extension, depending on which configuration you prefer to set your lift up in (There are 2 positions on the Front Extension for mounting - allowing 3 separate configurations). Simply bolt the Movable Clamp onto the left side of the Lift as you look at it from the rear using the provided bolts. Next, mount the Fixed Clamp onto the right side of the lift.

The PSE TCML & PSE TCMLW both come with an Adjustable Front Wheel Stop. To install this piece, simply use the pin provider onto the front of the Table Assembly or Front Extension, again depending on which configuration you opt to use for your lift.

Note: It is adjustable to use eye bolts to screw and fasten the equipment to the table with heavy duty straps.

Please see the pictures below for proper installation of the Wheel Vise.



Figure 4.2

Reference pictures for proper Wheel Vise installation.

4.6 SIDE EXTENSION INSTALLATION (TCMLW)

The Side Extensions for the PSE TCMLW are easily installed. There are 3 Extension Tubes provided for installation which also includes a stabilizing bar. The 2 Short Extension Tubes are slid into the holes on the back of the Table Assembly at the opposite end of the vise by the rear Approach Ramp. You must secure the Short Extension Tubes to the Table Assembly by using 1 screw in each Tube under the table to lock them in place once they are installed. The Long Extension Tube runs all the way through, underneath the front side of the Table Assembly.

You must remove both End Caps, slide the Stabilizing Bar through the square holes on the rear locking Scissor Legs and then reattach the End Caps to the Stabilizer Bar. Slide the 2 Side Extensions over the Tubes and insert the Quick Pins in the appropriate holes at the end of the round tubes to secure the Table Extensions to the lift. For the Approach Ramp, use the provided bolts and nuts to secure the Ramp Extensions onto the Approach Ramp on each side.

Please see the pictures below for proper installation of the Side Extensions.

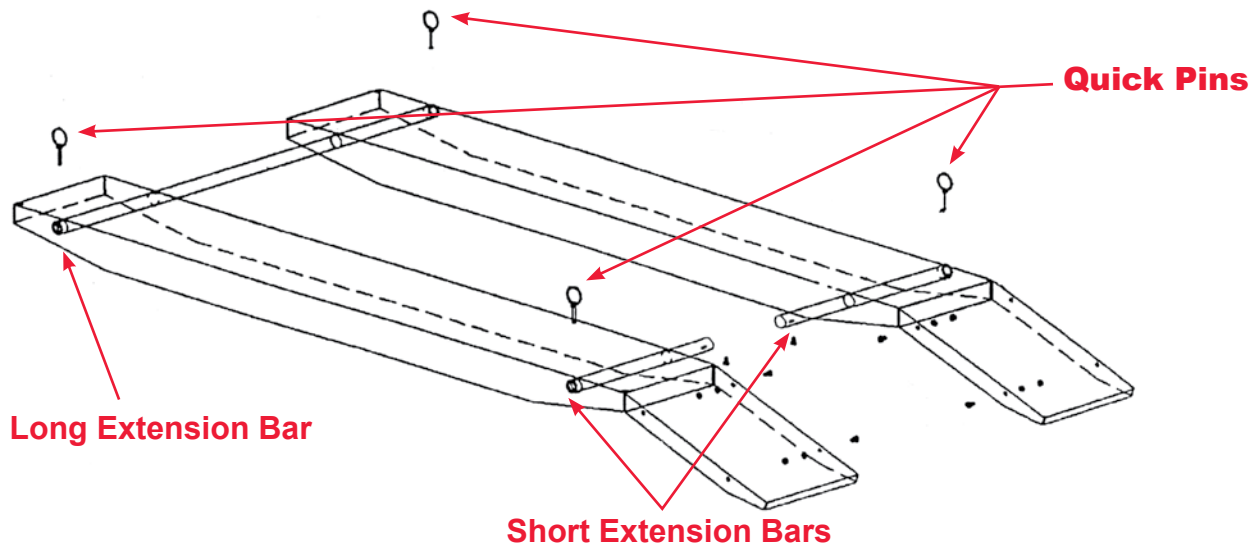

**NOTE: YOU CAN INSTALL
THE SIDE EXTENSIONS
TURNED 180° AND USE
THEM AS TOOL TRAYS!**



5.1 Check The Safety Lock Assembly:

1. **WARNING!** Never operate the Lift if the Safety Lock Assembly is not working.
2. **ALWAYS RELEASE THE MANUAL SAFETY LOCK LATCH BAR ONCE AIR PRESSURE IS APPLIED THROUGH THE FOOT PEDAL TO THE CYLINDER AND THE LIFT STARTS TO RAISE.**
3. Raise the lift all the way with no load on the lift.
4. With the lift fully raised, ensure the Safety Latch Bar is down so it will engage on the Locks. With the Locking Bar in position, always lower the Lift until the Safety Bar rests on a Lock and supports the Lift.
5. **THIS TEST SHOULD BE DONE ON A DAILY BASIS TO INSURE SAFETY BAR IS WORKING CORRECTLY!**



CAUTION: If the Safety Lock Assembly does not engage, fully lower the Lift and have a PSE qualified service technician immediately repair the Safety Lock Assembly or contact your distributor. **(DO NOT USE THE LIFT UNTIL THE SAFETY LOCKING SYSTEM IS WORKING PROPERLY.)**

5.2 To Position, Lift, And Lower Equipment On The Lift:

1. Before pushing equipment onto the Lift make sure that the Lift is fully lowered, and the approach ramps are attached and resting on the floor. Also, for two wheel equipment, ensure that the Front Wheel Vise is opened up enough to fit the equipment's front wheel. Loads must be centered on the table at all times. The center of the table is rated for a maximum load of 1,500 lbs.
2. Push the equipment over the Lift while keeping the equipment parallel with the Lift and aligning the center of gravity of the equipment with the center of the Lift. For motorcycles and other two wheel vehicles/equipment, push forward until the front wheel goes between the clamps on the Front Wheel Vise. **DO NOT DRIVE EQUIPMENT ONTO OR OFF OF THE LIFT! PERSONAL INJURY MAY OCCUR WHILE STEPPING DOWN FROM THE EQUIPMENT, AND CAN ALSO CAUSE SERIOUS DAMAGE TO THE LIFT! PUSH EQUIPMENT ONTO THE LIFT WITHOUT PASSENGERS! AGAIN, NEVER DRIVE EQUIPMENT ONTO YOUR LIFT!**
3. Engage the parking brake of the equipment if applicable.
4. Once the equipment is parked and the ignition is turned off, secure the equipment to the lift by tightening the Front Wheel Vise **(WARNING: Make sure to only tighten the Front Wheel Vise enough to create a snug grip on the wheel. Do NOT overtighten the clamp as this can possibly damage your wheel.)**
5. Before Lifting: **Always tie down the equipment using straps through the tie down eyelets mounted on the lift's table surface DO THIS EVERY TIME BEFORE OPERATING LIFT!**
6. To raise the lift, use the foot pedal control to feed air to the lift. Once the lift reaches the desired height, return the foot pedal to a neutral position.
7. Always secure the lift using the safety locking system by grabbing the orange / red safety bar and swinging it down. Once a lock is in position, lower the lift using the foot pedal control until it rests on that lock.

(Continued On Next Page)

- To lower the lift, raise the lift up off of the safety lock using the air foot pedal control, then, when the locking bar is free, swing the bar back up to its mounting point underneath the lift. Now that the safety lock is disengaged, you can lower the lift using the air foot pedal control to the ground.
- Untie the equipment, you can now release the Front Wheel Vise, and push it off of the lift. **ONCE AGAIN, DO NOT DRIVE EQUIPMENT ONTO OR OFF OF THE LIFT!**

5.3 Safety Lock Operation

AGAIN, THE PROPER OPERATION OF THE LIFT REQUIRES THAT ANY TIME YOU RAISE EQUIPMENT, YOU MUST LOWER THE LIFT ONTO THE SAFETY LOCKS. As soon as you give the Foot Peddle air to go up to the cylinder release the Safety Bar this is done by swinging the Lock Bar down into the locking ladder, by raising or lowering the lift using the foot pedal controls until the Lock Bar rests on the next available lock. Note: The Foot Peddle is not made to hold the load for any extended periods of time and will bleed down onto the locks.

To lower the equipment, you must first raise the lift off of the locks using the foot pedal control. Then, when the locking bar is free, swing the bar back up to its mounting point underneath the lift. Now that the safety lock is disengaged, you can lower the lift using the air foot pedal control to the ground.



NEVER WORK UNDER OR NEAR THIS LIFT WITHOUT THE LOCKS BEING ENGAGED. NEVER LEAVE RAISED EQUIPMENT ON THE LIFT UNATTENDED. THE FOOT PEDDLE IS NOT DESIGNED TO BE A LOAD-HOLDING DEVICE. NOT USING THE SAFETY LOCKS WILL RESULT IN A PREMATURE FAILURE OF THE CYLINDER AND/OR HOSES AND CAN CAUSE SERIOUS PROPERTY DAMAGE OR PERSONAL INJURY! FAILURE TO HEED THIS WARNING WILL RESULT IN IMMEDIATE TERMINATION OF YOUR WARRANTY.

6.0 Maintenance Schedule

The following periodic maintenance is the suggested minimum requirements and minimum intervals; accumulated hours or monthly period, which ever comes sooner. If you hear a noise or see any indication of possible failure - cease operation immediately and inspect, correct and/or replace parts as required. Following these maintenance procedures is the key to prolonging the useful life of your lift. We highly recommend using a PSE Authorized Technician for all repairs and modifications.

IF AT ANY TIME YOU'RE NOT SURE OF THE SAFE OPERATION OF THE LIFT, DISCONTINUE USING IT AND CALL YOUR DISTRIBUTOR FOR ASSISTANCE.



Warning OSHA and ANSI require PSE authorized users to inspect lifting equipment at the start of every shift. These and other daily periodic inspections are the responsibility of the user.

6.1 Daily Pre-Operation Check

The user should at least perform the following checks daily.

- **Daily check of Safety Locking/Latch System is very important - the discovery of device failure could save you from expensive property damage, lost production time, serious personal injury and even death.**
- Check to insure safety latches for free movement and full engagement with lift are working.
- Check pneumatic connections, and hoses for leakage.
- Check the Cylinder Rod, if it becomes dry, lightly oil it.
- Check all bolts, nuts, and screws and tighten.
- Keep lift free of dirt, grease or any other corrosive substances.
- You should use an oil air regulator to keep the Cylinder dry and clean from contamination of the Air Compressor
- Release the water from your Air Compressor daily to insure no water contaminates the Foot Peddle, Hose and Hydraulic Cylinder.
- The Oiler should supply a mist of oil to the Foot Peddle, Hose and Hydraulic Cylinder for lubrication every 10 cycles up and down.

6.2 Weekly Maintenance

- Check air hoses and fittings for leaks and make sure connections are tightened.
- Check and tighten bolts, nuts, and all screws. Pivot Shaft set screws should always be checked to insure that they are tight.
- Check the Cylinder Rod, if it becomes dry, lightly oil it.
- Lubricate the grease zerks located at either end of the Pivot Shaft.
- Lubricate the grease zerks at the top end of the inside frame assembly.

6.3 Six Month Annual Maintenance

- Lubricate the grease zerks located at either end of the Pivot Shaft.
- Lubricate the grease zerks at the top end of the inside frame assembly.
- Squirt some oil through the bleed hole in the Plate End of the Cylinder to lubricate the Piston.

6.4 The following repairs should only be performed by a PSE authorized trained maintenance expert:

- Replacement of shafts / axles.
- Replacement of roll bearings.
- Replacement or rebuilding pneumatic/air cylinders.
- Checking pneumatic cylinder rods and rod ends (threads) for deformation or damage.
- Checking cylinder mounting to make sure its not lose and /or damage.

Relocating or changing components may cause problems. Each component in the system must be compatible; an undersized or restricted line will cause a drop in pressure. All Foot Peddle, and hose connections should be sealed and/or capped until just before use. Air hoses can be used to clean fittings and other components. However, the air supply must be filtered and dry to prevent contamination. Most important - cleanliness - contamination is the most frequent cause of malfunction or failure of pneumatic equipment, so always use an oil/air regulator.

7.1 Parts Breakdown

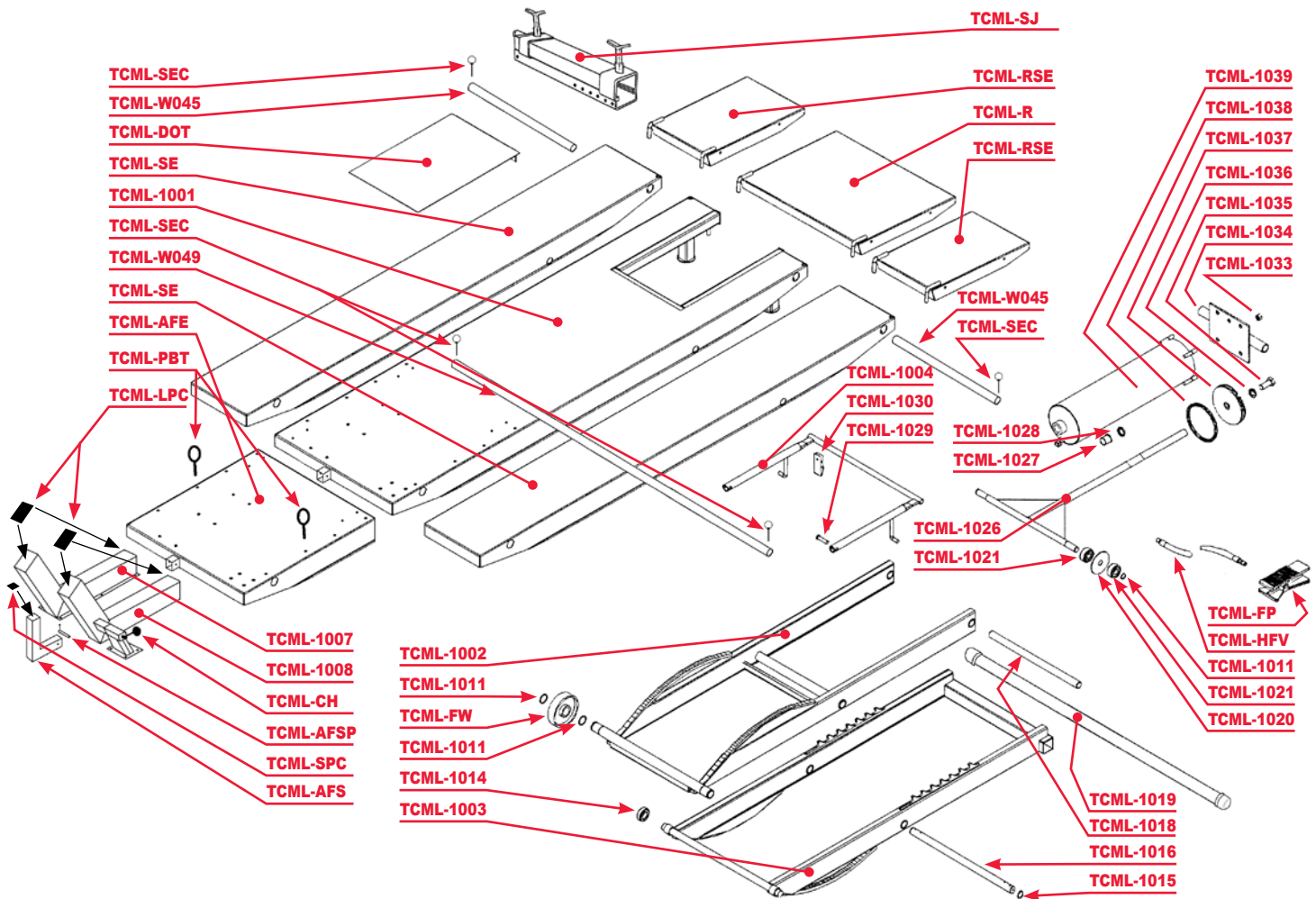

FIGURE 2 (Parts Drawing)

TCML-1001	Table Assembly
TCML-1002	Cylinder Pivot
TCML-1003	Frame Pivot
TCML-1004	Safety Lock Bar
TCML-R	Ramp (Approach)
TCML-AFE	Adjustable Front Extension
TCML-1007	Fixed Clamp
TCML-1008	Movable Clamp
TCML-AFS	Adjustable Front Stop
TCML-AFSP	Adjustable Front Stop Pin
TCML-1011	Retaining Ring
TCML-FW	Front Wheel
TCML-1014	Track Roller Bearing
TCML-1015	1-1/4" Retaining Ring

TCML-1016	Frame Pivot Shaft
TCML-1018	Cylinder Pivot Shaft
TCML-1019	Screw Cap Stabilizer Bar
TCML-1020	Cam Bearing Spacer
TCML-1021	Cam Roller Bearing
TCML-HFV	Hose w/ Fitting & Valve
TCML-FP	Foot Pedal Assembly
TCML-1026	Cylinder Shaft Assembly
TCML-1027	Cylinder Bushing
TCML-1028	Cylinder Shaft Seal
TCML-1029	Clevis Pin
TCML-1030	Safety Lock Bar Clip
TCML-1033	Cylinder Bolt
TCML-1034	Cylinder End Plate
TCML-1035	3/4"-10" x 1"-3/4" Screw

TCML-1036	3/4" Lockwasher
TCML-1037	Piston
TCML-1038	Piston Seal
TCML-1039	Cylinder
TCML-DOT	Drop Out Tail
TCML-SE	Side Extension
TCML-RSE	Ramp Side Extension
TCML-W045	Short Extension Pipe
TCML-SEC	Side Extension Clip
TCML-W049	Front Long Extension Pipe
TCML-SJ	Service Jack
TCML-PBT	Tie Downs (Parts Bag)
TCML-SPC	Small Plastic Cover
TCML-LPC	Large Plastic Cover
TCML-CH	Crank Handle for AFS

ATTENTION: MAIL TODAY TO ACTIVATE YOUR WARRANTY !

WARRANTY IS NON-TRANSFERABLE

Company Name: _____

Owner / Shop Manager: _____

Address: _____

Phone: () _____ Fax: () _____ Cell: () _____

City/State/Province/Zip: _____

E-mail: _____

PSE TCML & PSE TCMLW Motorcycle Lift

Model No.:	PSE TCML & PSE TCMLW
Capacity:	1,500 lbs.
Serial No.:	_____
Date:	_____



Purchased From: _____ Purchase Date: _____

Address: _____

City: _____ State: _____ Zip: _____

Office Phone: () _____ Cell Phone: () _____

Pro-Series Equipment
P.O. Box 734
Franklin, IN

Pro-Series Equipment
P.O. Box 734
Franklin, Indiana
ATTN: Warranty Dept.

Place
Stamp
Here